



JACKSONVILLE WASTEWATER UTILITY
248 Cloverdale Rd.
Jacksonville, AR 72076
501-982-0581

No. 10-0000284

RESIDENTIAL OR COMMERCIAL BUILDING SEWER CONNECTION PERMIT

Street Address 100 East Blvd

Legal Description _____

Facility to be connected to sewer:

Single Family Residence ☒ *Multi-family Residential _____ Units _____

*Commercial Installation _____ Description: Replacement

Water Meter (s) Size 5/8

* Commercial installations, and multi-family installations of more than 4 dwelling units must be accompanied by a site plan showing the proposed building sewer.

Sewer line installation by Precision Plumbing SLD

Address 80P 100 100 349 ←,bb7 411 343

General C _____

Address _____

In consider _____

1. To acc _____

2. To ma public _____

3. To not to the EAST BLD.

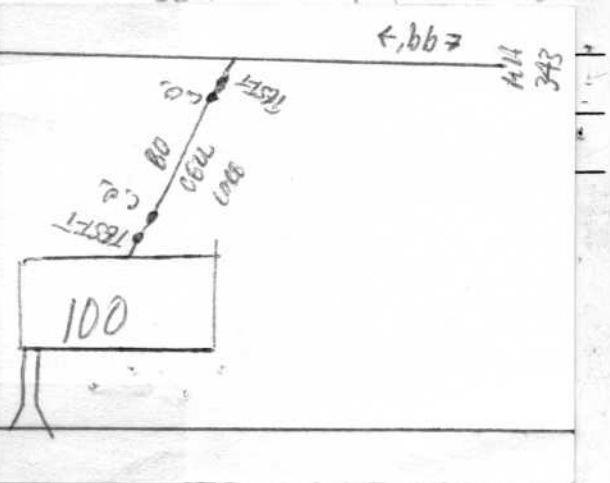

Fees: Connection Fee \$ _____ Receipt No. _____

Tap Charge \$ _____ Receipt No. _____

Inspection Fee \$ 250 Receipt No. on acct

Street Cut \$ _____ Receipt No. _____

APPLICANT
Signed on file

- ☐ Plumbing Contractor
☐ General Contract
☐ Owner (Address _____)

APPROVED
Jacksonville Wastewater Utility

By: Dustin Hurd Date: 11/8/10

12/3/10
complete