



No. 03-0042

JACKSONVILLE WASTEWATER UTILITY248 Cloverdale Road · P.O. Box 69
Jacksonville, AR 72078-0069
982-0581**RESIDENTIAL OR COMMERCIAL BUILDING SEWER CONNECTION PERMIT**Street Address 100 Harold Street

Legal Description _____

Facility to be connected to sewer:

Single Family Residence _____ *Multi-family Residential _____ Units _____

*Commercial Installation _____ Description: Replacement

Water Meter (s) Size _____

* Commercial installations, and multi-family installations of more than 4 dwelling units must be accompanied by a site plan showing the proposed building sewer.

Sewer line installation by AAA Plumbing Shop

Address _____

General _____

Address _____

In connection with _____

1. To _____

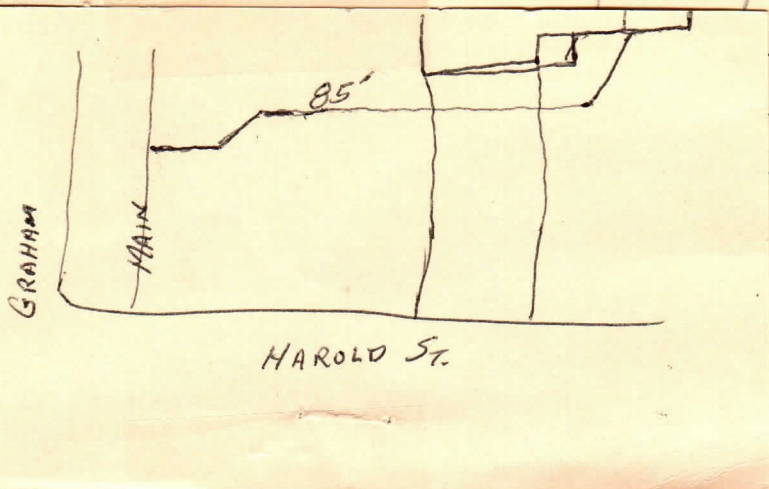
2. To _____
public _____3. To _____
to the _____

Fees: Connection Fee \$ _____

Receipt No. _____

Tap Charge \$ _____

Receipt No. _____

Inspection Fee \$ 6.00Receipt No. 7382

Street Cut \$ _____

Receipt No. _____

APPLICANTSigned on file☐ Plumbing Contractor☐ General Contract☐ Owner (Address _____)**APPROVED**

Jacksonville Wastewater Utility

By: [Signature] Date: 04-10-03



JACKSONVILLE WASTEWATER UTILITY

248 Cloverdale Rd.
Jacksonville, AR 72076
501-982-0581

No. 12-0059

RESIDENTIAL OR COMMERCIAL BUILDING SEWER CONNECTION PERMIT

Street Address 100 Harold

Legal Description _____

Facility to be connected to sewer:

Single Family Residence _____ *Multi-family Residential _____ Units _____

*Commercial Installation _____ Description: repair

Water Meter (s) Size _____

* Commercial installations, and multi-family installations of more than 4 dwelling units must be accompanied by a site plan showing the proposed building sewer.

Sewer line installation by AOK Plumbing

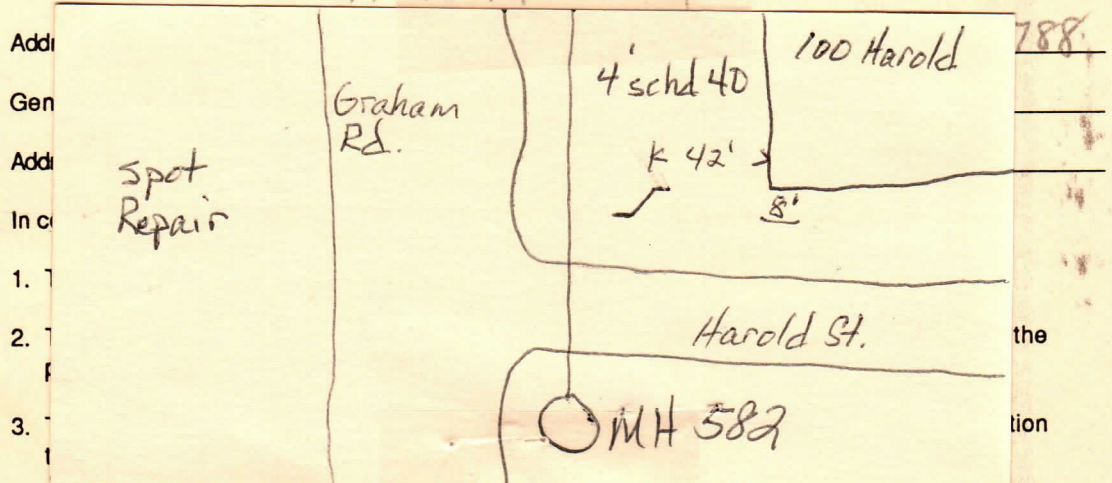

Fees: Connection Fee \$ _____

Receipt No. _____

Tap Charge \$ _____

Receipt No. _____

Inspection Fee \$ 25.00

Receipt No. 390134

Street Cut \$ _____

Receipt No. _____

APPLICANT

Signed _____

☒ Plumbing Contractor

☐ General Contract

☐ Owner (Address A-OK Plumbing)

APPROVED
Jacksonville Wastewater Utility

By: Theresa Hughes Date: 5-3-12

Completed
5/3/12