



**JACKSONVILLE WASTEWATER UTILITY**  
248 Cloverdale Rd.  
Jacksonville, AR 72076  
501-982-0581

No. 23- 0024

**RESIDENTIAL OR COMMERCIAL BUILDING SEWER CONNECTION PERMIT**

Street Address 100 Magnolia Ct

Legal Description Graham Woods p114 lot 23

Facility to be connected to sewer:

Single Family Residence ✓ \*Multi-family Residential \_\_\_\_\_ Units \_\_\_\_\_

\*Commercial Installation \_\_\_\_\_ Description: New connection

Water Meter (s) Size 3/8

\* Commercial installations, and multi-family installations of more than 4 dwelling units must be accompanied by a site plan showing the proposed building sewer.

Sewer line installation by Jackson plumbing

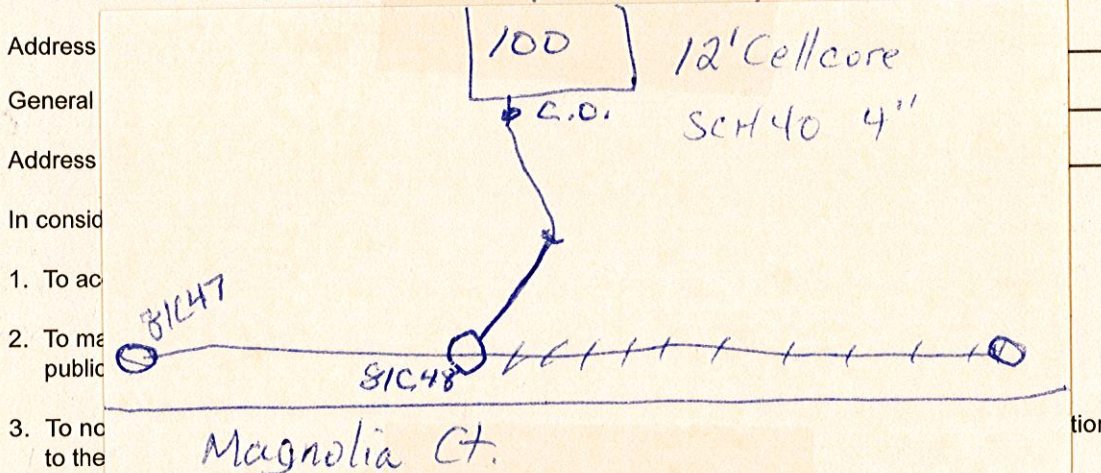

Fee: Connection Fee \$ 75.00 12/1/2023 Receipt No. 522051

Tap Charge \$ \_\_\_\_\_ Receipt No. \_\_\_\_\_

Inspection Fee \$ 25.00 6/13/2023 Receipt No. 522150

Street Cut \$ \_\_\_\_\_ Receipt No. \_\_\_\_\_

APPLICANT  
Signed [Signature]

- ☐ Plumbing Contractor  
☐ General Contract  
☐ Owner (Address \_\_\_\_\_)

Complete  
10/4/2023

APPROVED  
Jacksonville Wastewater Utility

By: Bradshaw Date: 1.18.23