



JACKSONVILLE WASTEWATER UTILITY
248 Cloverdale Rd.
Jacksonville, AR 72076
501-982-0581

No. 06- 0317

RESIDENTIAL OR COMMERCIAL BUILDING SEWER CONNECTION PERMIT

Street Address 1000 Elkhorn Ct
Legal Description 2186 Walnut Pointe Lakes Ph VII

Facility to be connected to sewer:

Single Family Residence ☒ *Multi-family Residential _____ Units _____

*Commercial Installation _____ Description: _____

Water Meter (s) Size 3/8"

* Commercial installations, and multi-family installations of more than 4 dwelling units must be accompanied by a site plan showing the proposed building sewer.

Sewer line installation by Harden Plumbing

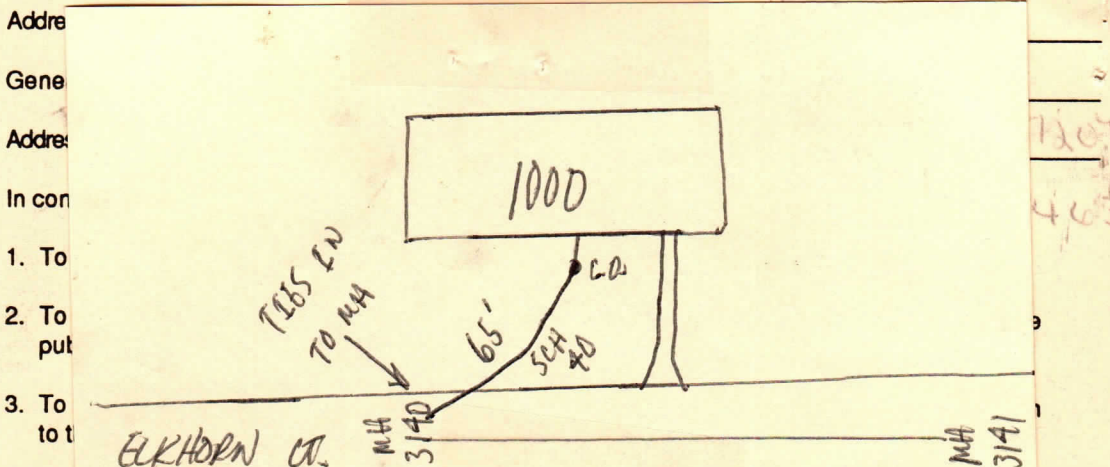

Fees: Connection Fee \$ 2870 Receipt No. 21001
Tap Charge \$ _____ Receipt No. _____
Inspection Fee \$ 12.00 Receipt No. on acct
Street Cut \$ _____ Receipt No. _____

APPLICANT Signed Robert K. [Signature]
☐ Plumbing Contractor
☐ General Contract
☐ Owner (Address _____)

APPROVED
Jacksonville Wastewater Utility
By: Jessica Kendrick Date: 12-4-06

Inspected
7-25-07