



No. 09- 0081

JACKSONVILLE WASTEWATER UTILITY
248 Cloverdale Rd.
Jacksonville, AR 72076
501-982-0581

RESIDENTIAL OR COMMERCIAL BUILDING SEWER CONNECTION PERMIT

Street Address 1000 Graham Rd

Legal Description _____

Facility to be connected to sewer:

Single Family Residence ☒ *Multi-family Residential _____ Units _____

*Commercial Installation _____ Description: New Connection

Water Meter (s) Size 5/8"

* Commercial installations, and multi-family installations of more than 4 dwelling units must be accompanied by a site plan showing the proposed building sewer.

Sewer line installation by Master Plumbing 993-4535

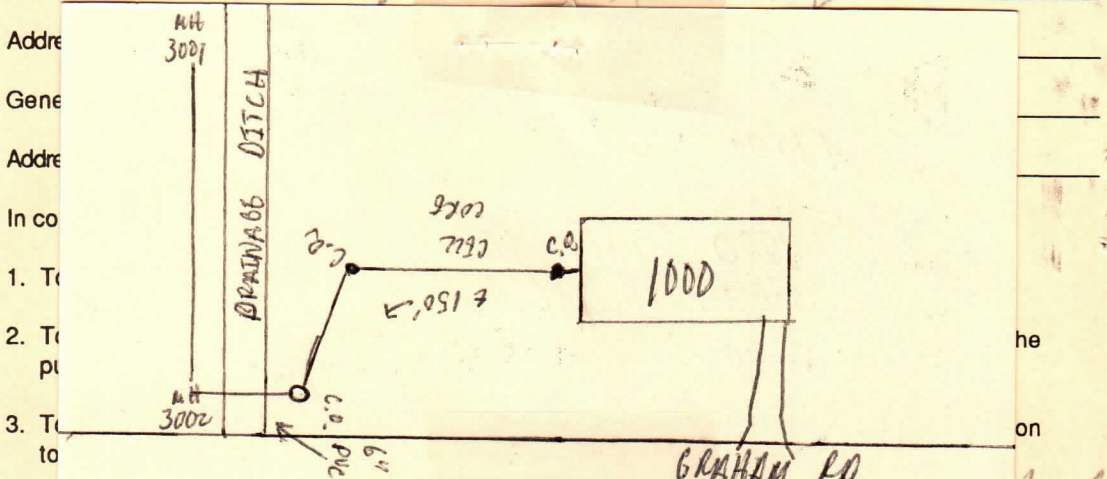

Fees: Connection Fee \$ 15.00

Receipt No. on Acct

Tap Charge \$ _____

Receipt No. _____

Inspection Fee \$ 25.00

Receipt No. on Acct

Street Cut \$ _____

Receipt No. _____

APPLICANT

Signed [Signature]
☐ Plumbing Contractor
☐ General Contract
☐ Owner (Address _____)

APPROVED
Jacksonville Wastewater Utility

By: Jessica Leidenk Date: 4/10/09

Completed
4/10/09

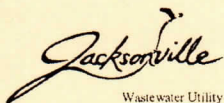

JACKSONVILLE WASTEWATER UTILITY

248 Cloverdale Rd.
Jacksonville, AR 72076
501-982-0581

No. 12-0091

RESIDENTIAL OR COMMERCIAL BUILDING SEWER CONNECTION PERMIT

Street Address 1000 Graham Rd

Legal Description _____

Facility to be connected to sewer:

Single Family Residence ☒ *Multi-family Residential _____ Units _____

*Commercial Installation _____ Description: Residential SL

Water Meter (s) Size 5/8"

* Commercial installations, and multi-family installations of more than 4 dwelling units must be accompanied by a site plan showing the proposed building sewer.

Sewer line installation by WU Cody

Address _____

General _____

Address _____

In con _____

1. To _____

2. To _____
pul _____

3. To _____
to _____

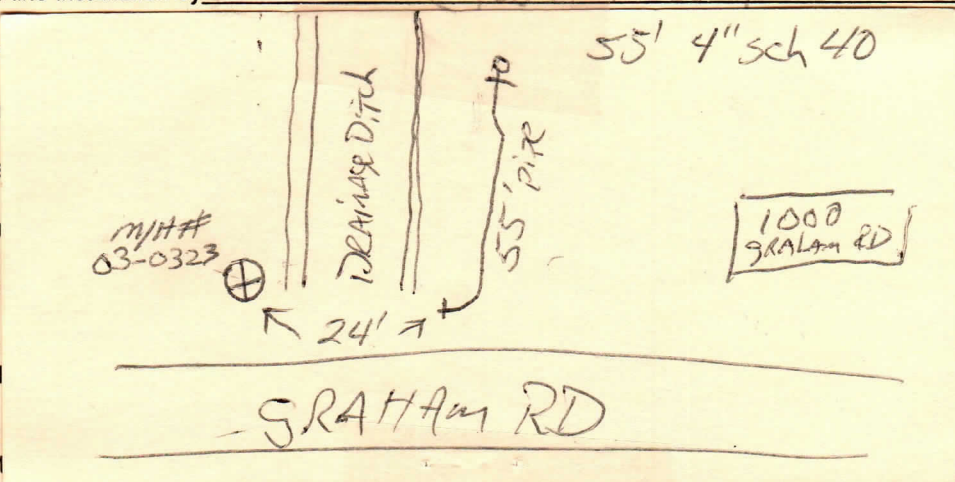

Fees: Connection Fee \$ _____

Receipt No. _____

Tap Charge \$ _____

Receipt No. _____

Inspection Fee \$ 0

Receipt No. N/C

Street Cut \$ _____

Receipt No. _____

APPLICANT

Signed _____

☐ Plumbing Contractor

☐ General Contract

☐ Owner (Address _____)

APPROVED

Jacksonville Wastewater Utility

By: Anna Rendile Date: 7/5/12



JACKSONVILLE WASTEWATER UTILITY

248 Cloverdale Rd.
Jacksonville, AR 72076
501-982-0581

No 16- 0152

RESIDENTIAL OR COMMERCIAL BUILDING SEWER CONNECTION PERMIT

Street Address 1000 Graham Rd

Legal Description _____

Facility to be connected to sewer:

Single Family Residence ☒ *Multi-family Residential _____ Units _____

Commercial Installation _____ Description: Capping Service Line

Water Meter (s) Size 5/8

Commercial installations, and multi-family installations of more than 4 dwelling units must be accompanied by a site plan showing the proposed building sewer.

Sewer line installation by Master Plumbing 982-5042

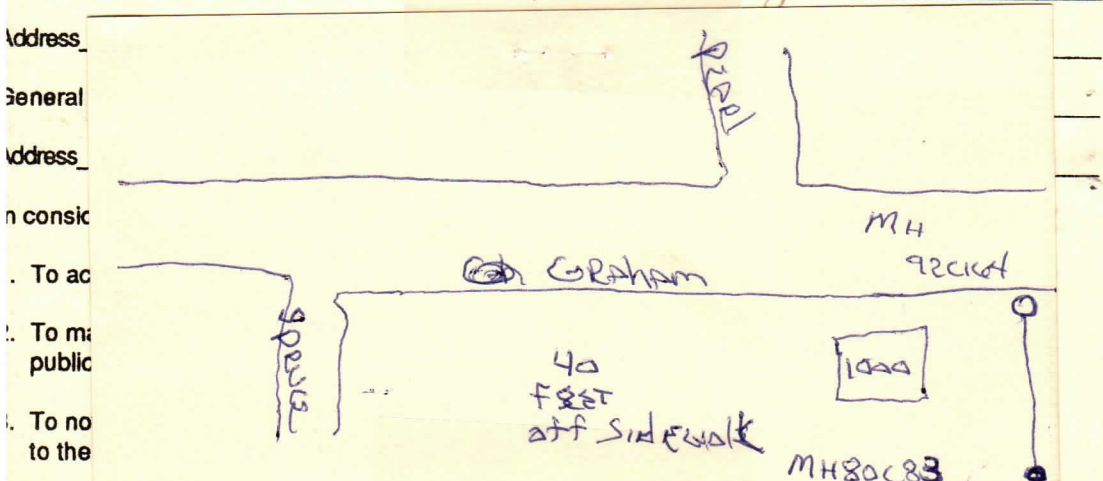

Fees:	Connection Fee	\$ _____	Receipt No. _____
	Tap Charge	\$ _____	Receipt No. _____
	Inspection Fee	\$ <u>25.00</u>	Receipt No. <u>504934</u>
	Street Cut	\$ _____	Receipt No. _____

APPLICANT

Signed _____

- ☐ Plumbing Contractor
☐ General Contract
☐ Owner (Address _____)

David M

APPROVED

Jacksonville Wastewater Utility

by: J. Ann White Date: 8/5/16

complete
8/4/16
WB