



JACKSONVILLE WASTEWATER UTILITY

248 Cloverdale Road · P.O. Box 69
Jacksonville, AR 72078-0069
982-0581

No. 05-0016

RESIDENTIAL OR COMMERCIAL BUILDING SEWER CONNECTION PERMIT

Street Address 1000 Madden Road

Legal Description _____

Facility to be connected to sewer:

Single Family Residence ☒ *Multi-family Residential _____ Units _____

*Commercial Installation _____ Description: Replacement

Water Meter (s) Size _____

* Commercial installations, and multi-family installations of more than 4 dwelling units must be accompanied by a site plan showing the proposed building sewer.

Sewer line installation by Starr Plumbing

Address _____

General _____

Address _____

In consid _____

1. To a _____

2. To m _____
publi _____

3. To n _____
to the _____

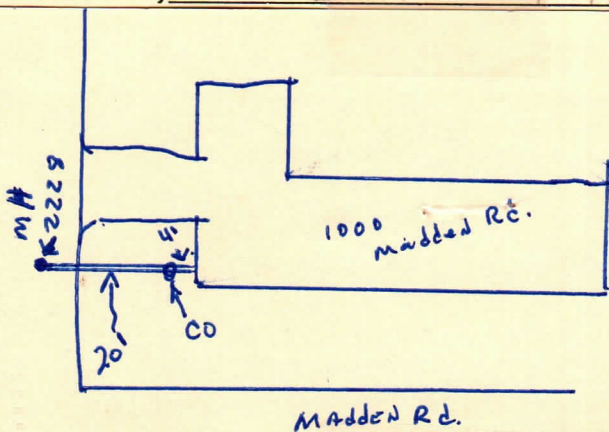

Fees: Connection Fee \$ _____ Receipt No. _____

Tap Charge \$ _____ Receipt No. _____

Inspection Fee \$ 12.00 Receipt No. 9001

Street Cut \$ _____ Receipt No. _____

APPLICANT
Signed Lyle Starr Lyle Starr

- ☐ Plumbing Contractor
☐ General Contract
☐ Owner (Address _____)

APPROVED
Jacksonville Wastewater Utility

By: Lyle Starr Date: 18 Feb. 2005