



No. 99 0161

JACKSONVILLE WASTEWATER UTILITY

248 Cloverdale Road · P.O. Box 69
Jacksonville, AR 72078-0069
982-0581

RESIDENTIAL OR COMMERCIAL BUILDING SEWER CONNECTION PERMIT

Street Address 1000 Richard

Legal Description _____

Facility to be connected to sewer:

Single Family Residence ☒ *Multi-family Residential _____ Units _____

*Commercial Installation _____ Description: Keep SSES

Water Meter (s) Size _____

* Commercial installations, and multi-family installations of more than 4 dwelling units must be accompanied by a site plan showing the proposed building sewer.

Sewer line installation by James Miller 9825162

Address 1000 Richard Jay

General

Address _____

In consid

1. To ac

2. To m
public

3. To no
to the

Fees:



JACKSONVILLE WASTEWATER UTILITY

SERVICE INSPECTION

PERMIT NO. _____

DATE: 5-27-99

OWNER: _____

ADDRESS: 1000 Richard

PLUMBER: _____

SERVICE LINE: OK ☒ REJECTED ☐ REASON: _____

SIGNED Paul Peters

Inspection Fee \$ 6.00

Receipt No. 9211

Total Fees \$ _____

APPLICANT

Signed James Miller

☐ Plumbing Contractor

☐ General Contract

☐ Owner (Address _____)

APPROVED

Jacksonville Wastewater Utility

By: Paul Peters Date: 5-27-99



JACKSONVILLE WASTEWATER UTILITY

248 Cloverdale Rd.
Jacksonville, AR 72076
501-982-0581

No. 07-0170

RESIDENTIAL OR COMMERCIAL BUILDING SEWER CONNECTION PERMIT

Street Address 1000 Richard Street

Legal Description _____

Facility to be connected to sewer:

Single Family Residence ☒ *Multi-family Residential _____ Units _____

*Commercial Installation _____ Description: Repair

Water Meter (s) Size 5/8"

* Commercial installations, and multi-family installations of more than 4 dwelling units must be accompanied by a site plan showing the proposed building sewer.

Sewer line installation by John Miller

Address _____

General Contractor _____

Address _____

In consideration of GREEN ACRES

1. To accept a
2. To maintain public sewer
3. To notify the public

Fees: Conn _____

Tap Charge \$ _____ Receipt No. _____

Inspection Fee \$ 12.00 Receipt No. 1176

Street Cut \$ _____ Receipt No. _____

APPLICANT

Signed [Signature]

☐ Plumbing Contractor

☐ General Contract

☐ Owner (Address James Miller)

APPROVED

Jacksonville Wastewater Utility

By: [Signature] Date: 12-20-07

Inspected
12-21-07

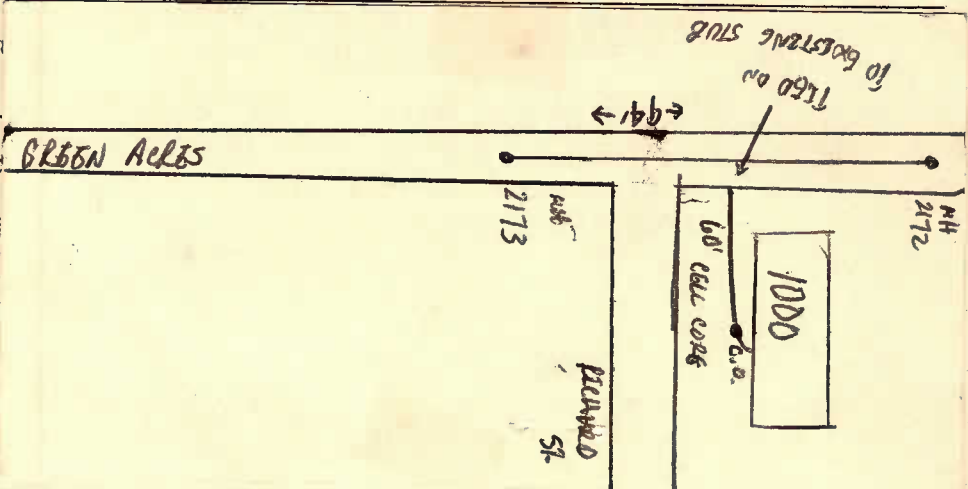



JACKSONVILLE WASTEWATER UTILITY

248 Cloverdale Rd.
Jacksonville, AR 72076
501-982-0581

No. 11-

037

RESIDENTIAL OR COMMERCIAL BUILDING SEWER CONNECTION PERMIT

Street Address 1000 Richards St

Legal Description _____

Facility to be connected to sewer:

Single Family Residence ☒ *Multi-family Residential _____ Units _____

*Commercial Installation _____ Description: Repair

Water Meter (s) Size 5/8"

* Commercial installations, and multi-family installations of more than 4 dwelling units must be accompanied by a site plan showing the proposed building sewer.

Sewer line installation by Will Wolke

Address _____

General Contractor _____

Address _____

In consideration of _____

1. To accept: GREEN ALLES RD.

2. To maintain public sewer 2/17/11 2/17/11

3. To notify the public 401-1000 Richards St

Fees: Conn _____

Tap Charge \$ _____ Receipt No. _____

Inspection Fee \$ 0 Receipt No. no charge

Street Cut \$ _____ Receipt No. _____

APPLICANT

Signed [Signature]

- ☐ Plumbing Contractor
☐ General Contract
☐ Owner (Address _____) Complete
3/10/11

APPROVED

Jacksonville Wastewater Utility

By: [Signature] Date: 3/10/11