



**JACKSONVILLE WASTEWATER UTILITY**  
248 Cloverdale Rd.  
Jacksonville, AR 72076  
501-982-0581

No. 23-0159

**RESIDENTIAL OR COMMERCIAL BUILDING SEWER CONNECTION PERMIT**

Street Address 1001 W. Main Street

Legal Description Arbys

Facility to be connected to sewer:

Single Family Residence \_\_\_\_\_ \*Multi-family Residential \_\_\_\_\_ Units \_\_\_\_\_

\*Commercial Installation ✓ Description: Repair

Water Meter (s) Size \_\_\_\_\_

\* Commercial installations, and multi-family installations of more than 4 dwelling units must be accompanied by a site plan showing the proposed building sewer.

Sewer line installation by Scroggins Roto Rooter Sam

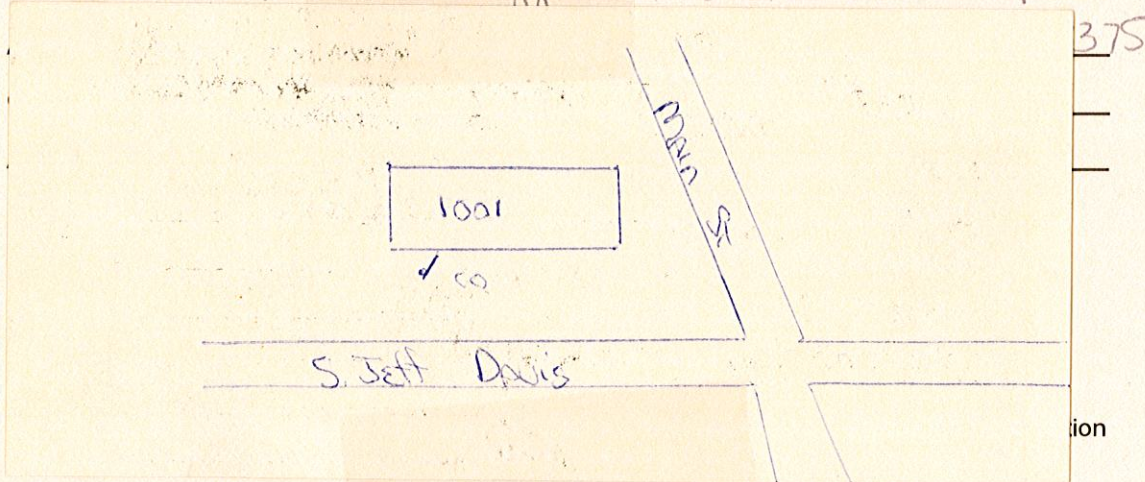

Fee:	Connection Fee	\$ _____	Receipt No. _____
	Tap Charge	\$ _____	Receipt No. _____
	Inspection Fee	\$ <u>25<sup>00</sup></u>	Receipt No. <u>in receipt</u>
	Street Cut	\$ _____	Receipt No. _____

**APPLICANT**

Signed on file

- ☐ Plumbing Contractor  
☐ General Contract  
☐ Owner (Address \_\_\_\_\_)

APPROVED  
Jacksonville Wastewater Utility

By: [Signature] Date: 11/14/2023

complete  
11/14/2023  
WJ