



NO. 02- 000091

## JACKSONVILLE WASTEWATER UTILITY

248 Cloverdale Road · P.O. Box 69  
Jacksonville, AR 72078-0069  
982-0581

## RESIDENTIAL OR COMMERCIAL BUILDING SEWER CONNECTION PERMIT

Street Address Right of the World Living  
10027 South Highway 161

Legal Description \_\_\_\_\_

Facility to be connected to sewer:

Single Family Residence \_\_\_\_\_ \*Multi-family Residential \_\_\_\_\_ Units \_\_\_\_\_

\*Commercial Installation ☒ Description: new connectionWater Meter (s) Size 1"

\* Commercial installations, and multi-family installations of more than 4 dwelling units must be accompanied by a site plan showing the proposed building sewer.

Sewer line installation by Mark's Plumbing

Add \_\_\_\_\_

Gen \_\_\_\_\_

Add \_\_\_\_\_

In c \_\_\_\_\_

1. T \_\_\_\_\_

2. T \_\_\_\_\_

F \_\_\_\_\_

3. T \_\_\_\_\_

to \_\_\_\_\_

Fee: \_\_\_\_\_

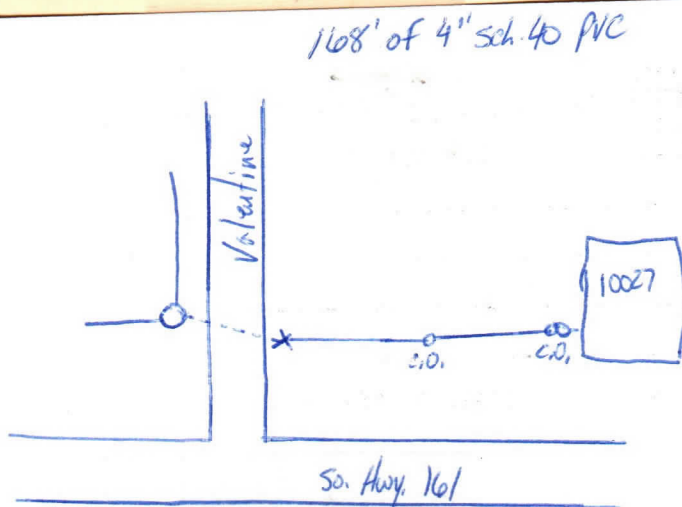

Tap Charge \$ \_\_\_\_\_

Receipt No. \_\_\_\_\_

Inspection Fee \$ 6.00Receipt No. 9255

Street Cut \$ \_\_\_\_\_

Receipt No. \_\_\_\_\_

## APPLICANT

Signed \_\_\_\_\_

☐ Plumbing Contractor☒ General Contract☐ Owner (Address \_\_\_\_\_)

## APPROVED

Jacksonville Wastewater Utility

By: Susan J. SmithDate: 4-30-02