



No. 03-0233

**JACKSONVILLE WASTEWATER UTILITY**248 Cloverdale Road • P.O. Box 69  
Jacksonville, AR 72078-0069  
982-0581**RESIDENTIAL OR COMMERCIAL BUILDING SEWER CONNECTION PERMIT**Street Address 1004 Colonial Dr.Legal Description Collenwood Lot # 7R

Facility to be connected to sewer:

Single Family Residence ☒ \*Multi-family Residential \_\_\_\_\_ Units \_\_\_\_\_

\*Commercial Installation \_\_\_\_\_ Description: \_\_\_\_\_

Water Meter (s) Size 5/8"

\* Commercial installations, and multi-family installations of more than 4 dwelling units must be accompanied by a site plan showing the proposed building sewer.

Sewer line installation by A-1 Plumbing

Address \_\_\_\_\_

General \_\_\_\_\_

Address \_\_\_\_\_

In consid \_\_\_\_\_

1. To acc \_\_\_\_\_

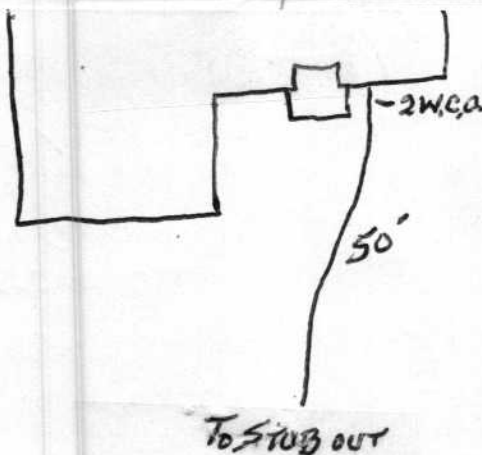
2. To ma  
public \_\_\_\_\_3. To not  
to the \_\_\_\_\_Fees: Connection Fee \$ 15. Receipt No. 2005

Tap Charge \$ \_\_\_\_\_ Receipt No. \_\_\_\_\_

Inspection Fee \$ 6.00 Receipt No. 2021 3/11/04Street Cut \$ 5.00 Receipt No. 2021 3/11/04**APPLICANT**

Signed \_\_\_\_\_

☐ Plumbing Contractor☐ General Contract☐ Owner (Address \_\_\_\_\_)**APPROVED**

Jacksonville Wastewater Utility

By: [Signature] Date: 9-29-03