



No. 97-

092

JACKSONVILLE WASTEWATER UTILITY

248 Cloverdale Road · P.O. Box 69
Jacksonville, AR 72078-0069
982-0581

RESIDENTIAL OR COMMERCIAL BUILDING SEWER CONNECTION PERMIT

Street Address 1006 Gregory

Legal Description _____

Facility to be connected to sewer:

Single Family Residence ☒ *Multi-family Residential _____ Units _____*Commercial Installation _____ Description: Repl SSESWater Meter (s) Size 5/8

* Commercial installations, and multi-family installations of more than 4 dwelling units must be accompanied by a site plan showing the proposed building sewer.

Sewer line installation by Maxson Plumbing

| | | | |
|----|---|--|------------------|
| Ad |  | JACKSONVILLE WASTEWATER UTILITY SERVICE INSPECTION | PERMIT NO. _____ |
| Ge | | | |
| Ad | | | |
| In | | | |
| 1. | DATE: <u>March 7, 1997</u> | | |
| 2. | OWNER: _____ | | |
| 3. | ADDRESS: <u>1006 Gregory</u> | | |
| | PLUMBER: <u>maxson</u> | | |
| | SERVICE LINE: <input checked="" type="checkbox"/> OK <input type="checkbox"/> REJECTED <input type="checkbox"/> REASON: <u>replace cleanout</u> | | |
| | SIGNED <u>Donald J. [Signature]</u> | | |

Tap Charge \$ _____

Receipt No. _____

Inspection Fee \$ 6.00Receipt No. 7148Total Fees \$ 6.007007

APPLICANT

Signed ☒ _____☐ Plumbing Contractor☐ General Contract☒ Owner (Address _____)

APPROVED

Jacksonville Wastewater Utility

By: Karen Stivers Date: 3-7-97



No. 05-0027

JACKSONVILLE WASTEWATER UTILITY248 Cloverdale Road • P.O. Box 69
Jacksonville, AR 72078-0069
982-0581**RESIDENTIAL OR COMMERCIAL BUILDING SEWER CONNECTION PERMIT**Street Address 1006 Gregory Street

Legal Description _____

Facility to be connected to sewer:

Single Family Residence _____ *Multi-family Residential _____ Units _____

*Commercial Installation _____ Description: _____

Water Meter (s) Size _____

* Commercial installations, and multi-family installations of more than 4 dwelling units must be accompanied by a site plan showing the proposed building sewer.

Sewer line installation by AAA Plumbing Shop

Address _____

General _____

Address _____

In connection with _____

1. To _____

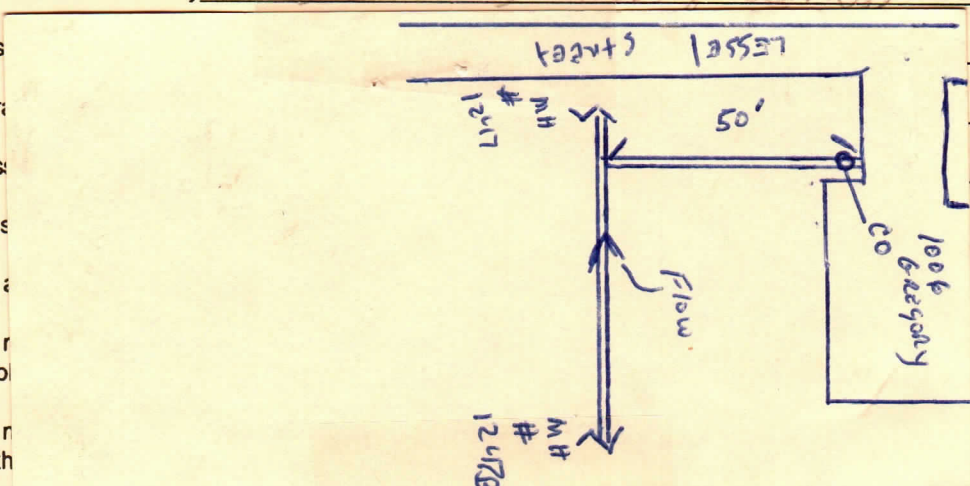
2. To _____
public _____3. To _____
to the _____

Fees: Connection Fee \$ _____

Receipt No. _____

Tap Charge \$ _____

Receipt No. _____

Inspection Fee \$ 12.00Receipt No. 9039

Street Cut \$ _____

Receipt No. _____

APPLICANTSigned on file☐ Plumbing Contractor☐ General Contract☐ Owner (Address _____)**APPROVED**

Jacksonville Wastewater Utility

By: Deane Gordon Date: 21 March 2005