



# JACKSONVILLE WASTEWATER UTILITY

248 Cloverdale Rd.  
Jacksonville, AR 72076  
501-982-0581

No. 15- 000127

## RESIDENTIAL OR COMMERCIAL BUILDING SEWER CONNECTION PERMIT

Street Address 1024 Puritan Drive

Legal Description Lot 22 Jayon Terrace Ph 10

Facility to be connected to sewer:

Single Family Residence X \*Multi-family Residential \_\_\_\_\_ Units \_\_\_\_\_

\*Commercial Installation \_\_\_\_\_ Description: New Connection

Water Meter (s) Size 5/8

\* Commercial installations, and multi-family installations of more than 4 dwelling units must be accompanied by a site plan showing the proposed building sewer.

Sewer line Installation by Abshure Plumbing - 590-4370

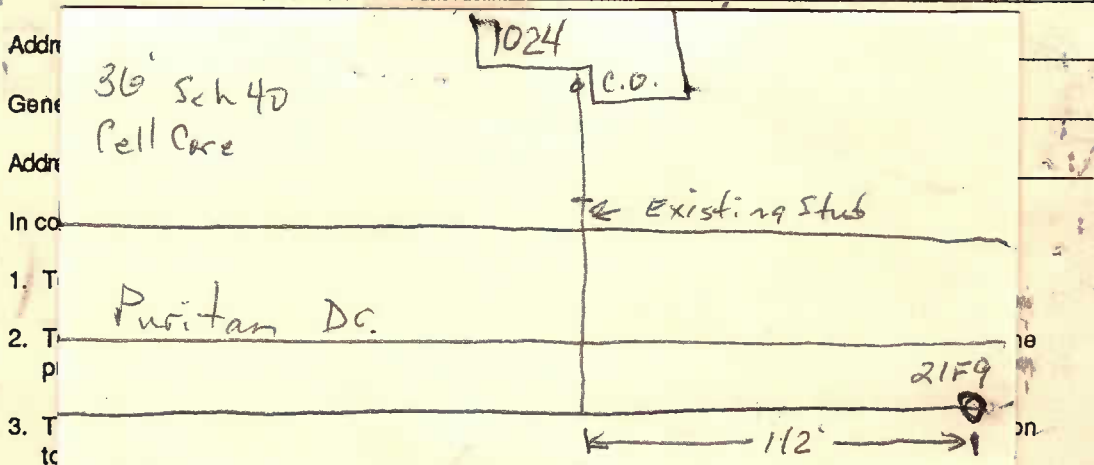

|       |                |                 |          |                            |
|-------|----------------|-----------------|----------|----------------------------|
| Fees: | Connection Fee | \$ <u>75.00</u> | 8/24/15  | Receipt No. <u>424144</u>  |
|       | Tap Charge     | \$ <u>101</u>   |          | Receipt No. _____          |
|       | Inspection Fee | \$ <u>25.00</u> | 10/15/15 | Receipt No. <u>on acct</u> |
|       | Street Cut     | \$ _____        |          | Receipt No. _____          |

APPLICANT Signed Sten Allgood

☐ Plumbing Contractor  
☐ General Contract  
☐ Owner (Address \_\_\_\_\_)

APPROVED  
Jacksonville Wastewater Utility

By: Vicki Hurl Date: 8/24/15

Waver

Completed  
10/15/15