



JACKSONVILLE WASTEWATER UTILITY

248 Cloverdale Road • P.O. Box 69
Jacksonville, AR 72078-0069
982-0581

No. 97-

235

RESIDENTIAL OR COMMERCIAL BUILDING SEWER CONNECTION PERMIT

Street Address 103 Central

Legal Description _____

Facility to be connected to sewer:

Single Family Residence X *Multi-family Residential _____ Units _____

*Commercial Installation _____ Description: Repr

Water Meter (s) Size 3/8

* Commercial installations, and multi-family installations of more than 4 dwelling units must be accompanied by a site plan showing the proposed building sewer.

Sewer line installation by AAA Plumbing

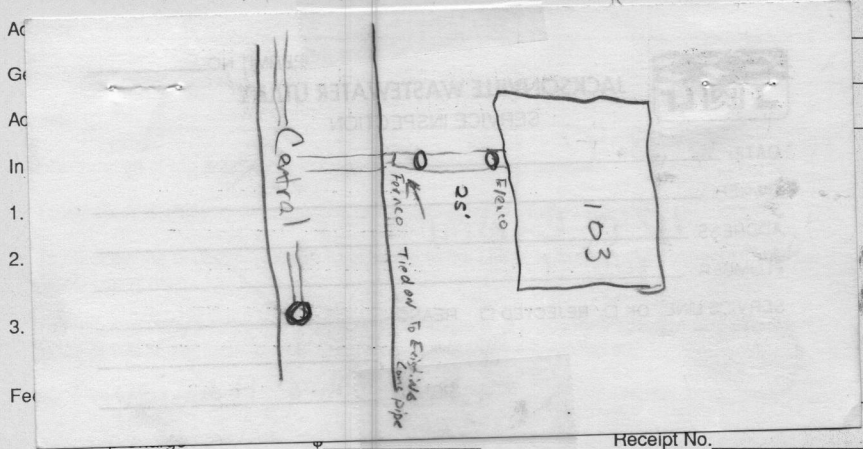

Inspection Fee \$ 6.00

Total Fees \$ _____

Receipt No. _____

Receipt No. 8287

APPLICANT

Signed Don Shon Sybil

- ☐ Plumbing Contractor
☐ General Contract
☐ Owner (Address _____)

APPROVED
Jacksonville Wastewater Utility

By: Karen Stivers Date: 6-18-97

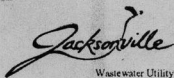

JACKSONVILLE WASTEWATER UTILITY
248 Cloverdale Rd.
Jacksonville, AR 72076
501-982-0581

No. 10-0000121

RESIDENTIAL OR COMMERCIAL BUILDING SEWER CONNECTION PERMIT

Street Address 103 Central

Legal Description _____

Facility to be connected to sewer:

Single Family Residence ☒ *Multi-family Residential _____ Units _____

*Commercial Installation _____ Description: Replacement SCD

Water Meter (s) Size 5/8

* Commercial installations, and multi-family installations of more than 4 dwelling units must be accompanied by a site plan showing the proposed building sewer.

Sewer line installation by Precision Plumbing Kevin 743-5500

Address _____

General _____

Address _____

In connection with _____

1. To _____

2. To _____

3. To _____

to _____

Fees: Connection Fee \$ _____ Receipt No. _____

Tap Charge \$ _____ Receipt No. _____

Inspection Fee \$ 25.00 Receipt No. 240819

Street Cut \$ _____ Receipt No. _____

APPLICANT Signed Phil Ndon

☐ Plumbing Contractor

☐ General Contract

☐ Owner (Address _____)

APPROVED
Jacksonville Wastewater Utility

By: Victoria Reed Date: 6/10/10



Upstream
Downstream

103 Central Ave
Mainline

Technician: Warren M.
Date: 3/22/10

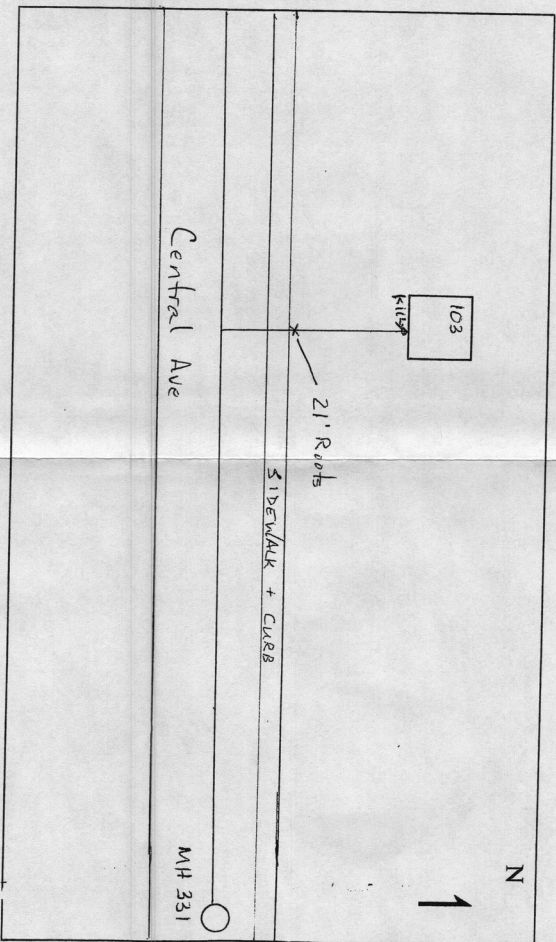

JWWU -- DEFECT SKETCH