



No. 93- 003

JACKSONVILLE WASTEWATER UTILITY248 Cloverdale Road · P.O. Box 69
Jacksonville, AR 72076
982-0581**RESIDENTIAL OR COMMERCIAL BUILDING SEWER CONNECTION PERMIT**Street Address 104 Redwing Road.Legal Description Lot 142 Tract 10

Facility to be connected to sewer:

Single Family Residence ☒ *Multi-family Residential _____ Units _____*Commercial Installation _____ Description: NewWater Meter (s) Size 7/8"

* Commercial installations, and multi-family installations of more than 4 dwelling units must be accompanied by a site plan showing the proposed building sewer.

Sewer line installation by Monteith Pltg. Div. M. Plumber

Address _____

General

Address _____

In consid

1. To ac

2. To m
public3. To no
to the

Fees:

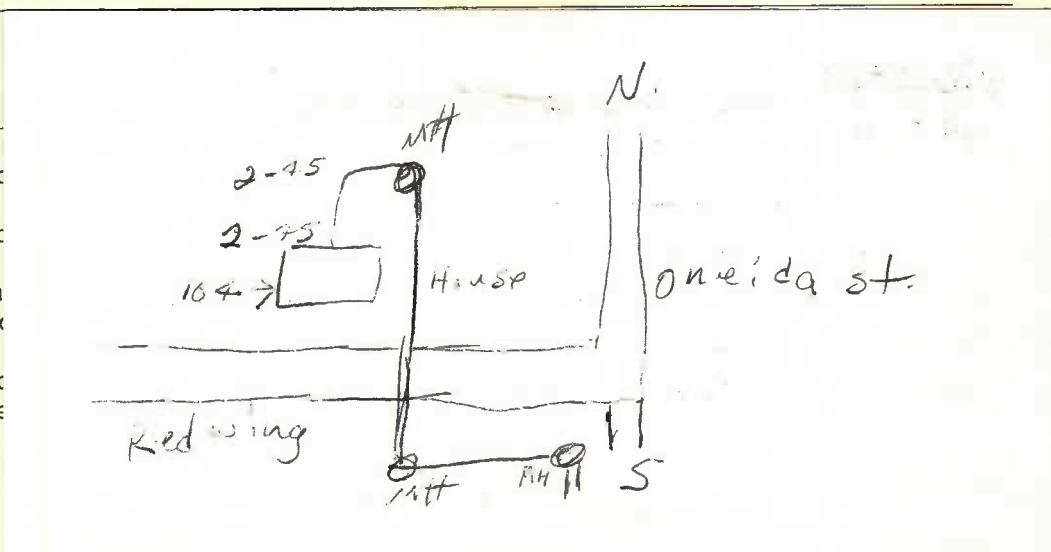
Inspection Fee \$ 61.00Receipt No. 1277 1/12/93Total Fees \$ 81.00

APPLICANT

Signed Thomas W. Dupre☐ Plumbing Contractor☐ General Contract☒ Owner (Address White Pine Lumber)

APPROVED

Jacksonville Wastewater Utility

By: Ma Hughes Date: 1/12/93