



No. 09- 0037

JACKSONVILLE WASTEWATER UTILITY
248 Cloverdale Rd.
Jacksonville, AR 72076
501-982-0581

RESIDENTIAL OR COMMERCIAL BUILDING SEWER CONNECTION PERMIT

Street Address 105 Chickasaw Place

Legal Description _____

Facility to be connected to sewer:

Single Family Residence ☒ *Multi-family Residential _____ Units _____*Commercial Installation _____ Description: RepairWater Meter (s) Size 5/8"

* Commercial installations, and multi-family installations of more than 4 dwelling units must be accompanied by a site plan showing the proposed building sewer.

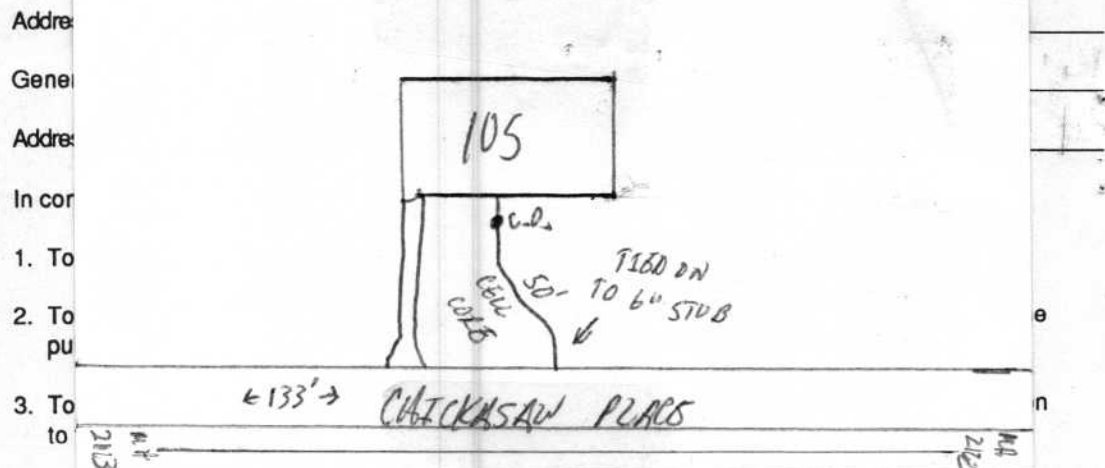
Sewer line installation by Anderson Plumbing 743-5000

Fees:	Connection Fee	\$ _____	Receipt No. _____
	Tap Charge	\$ _____	Receipt No. _____
	Inspection Fee	\$ <u>25.00</u>	Receipt No. <u>8136</u>
	Street Cut	\$ _____	Receipt No. _____

APPLICANT
Signed Charlotte Huregutte
☐ Plumbing Contractor
☐ General Contract
☐ Owner (Address 501-982-6395)

APPROVED
Jacksonville Wastewater Utility
By: Jessica Kendrick Date: 3/5/09

Completed
3/30/09