



JACKSONVILLE WASTEWATER UTILITY
248 Cloverdale Rd.
Jacksonville, AR 72076
501-982-0581

No. 24- **0044**

RESIDENTIAL OR COMMERCIAL BUILDING SEWER CONNECTION PERMIT

Street Address 108 Cross Street

Legal Description _____

Facility to be connected to sewer:

Single Family Residence _____ *Multi-family Residential _____ Units _____

*Commercial Installation _____ Description: Repair

Water Meter (s) Size _____

* Commercial installations, and multi-family installations of more than 4 dwelling units must be accompanied by a site plan showing the proposed building sewer.

Sewer line installation by Complete Plumbing Solutions

Address _____

General C _____

Address _____

In consider _____

1. To acc _____

2. To main _____
public s _____

3. To noti _____
to the p _____

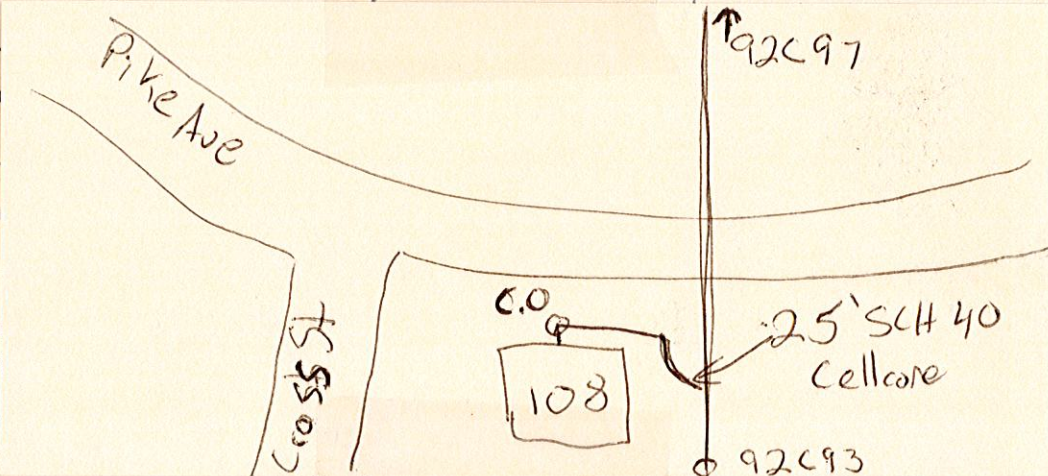

Fee: Connection Fee \$ 75.00 Receipt No. 515376

Tap Charge \$ _____ Receipt No. _____

Inspection Fee \$ 25.00 Receipt No. 515375

Street Cut \$ _____ Receipt No. _____

APPLICANT

Signed [Signature]

☐ Plumbing Contractor

☐ General Contract

☐ Owner (Address _____)

Complete
4/5/2024

APPROVED

Jacksonville Wastewater Utility

By: Cathy Reed Date: 4/5/24