



JACKSONVILLE WASTEWATER UTILITY  
248 Cloverdale Rd.  
Jacksonville, AR 72076  
501-982-0581

No. 09- 0061

RESIDENTIAL OR COMMERCIAL BUILDING SEWER CONNECTION PERMIT

Street Address 108 Military Road

Legal Description \_\_\_\_\_

Facility to be connected to sewer:

Single Family Residence ☒ \*Multi-family Residential \_\_\_\_\_ Units \_\_\_\_\_

\*Commercial Installation \_\_\_\_\_ Description: Repair

Water Meter (s) Size 5/8"

\* Commercial installations, and multi-family installations of more than 4 dwelling units must be accompanied by a site plan showing the proposed building sewer.

Sewer line installation by Arrow Plumbing

Address 540 MH 539 MH

General \_\_\_\_\_

Address \_\_\_\_\_

In consid \_\_\_\_\_

1. To ac \_\_\_\_\_

2. To ma \_\_\_\_\_  
public \_\_\_\_\_

3. To no \_\_\_\_\_  
to the MILITARY RD

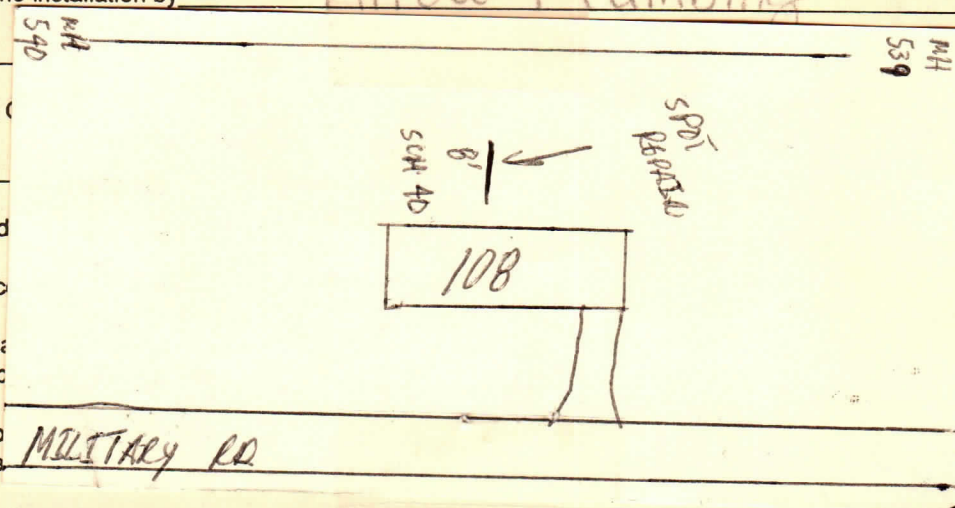

Fees: Connection Fee \$ \_\_\_\_\_ Receipt No. \_\_\_\_\_

Tap Charge \$ \_\_\_\_\_ Receipt No. \_\_\_\_\_

Inspection Fee \$ 25.00 Receipt No. on acct

Street Cut \$ \_\_\_\_\_ Receipt No. \_\_\_\_\_

APPLICANT

Signed on file

- ☒ Plumbing Contractor  
☐ General Contract  
☐ Owner (Address \_\_\_\_\_)

APPROVED

Jacksonville Wastewater Utility

By: Cathy Reed Date: 3/27/09

Completed  
3/27/09