



No. 05-0354

JACKSONVILLE WASTEWATER UTILITY248 Cloverdale Road • P.O. Box 69
Jacksonville, AR 72078-0069
982-0581**RESIDENTIAL OR COMMERCIAL BUILDING SEWER CONNECTION PERMIT**Street Address 1109 Stevenson CoveLegal Description Lot 55 Growing Pines

Facility to be connected to sewer:

Single Family Residence X *Multi-family Residential _____ Units _____

*Commercial Installation _____ Description: _____

Water Meter (s) Size 3/8

* Commercial installations, and multi-family installations of more than 4 dwelling units must be accompanied by a site plan showing the proposed building sewer.

Sewer line installation by Mulligan Plumbing Affordable Plumbing

Address _____

General C

Address Stevenson Cove

In consider

1. To acc

2. To mai
public s3. To noti
to the p

Fees: C

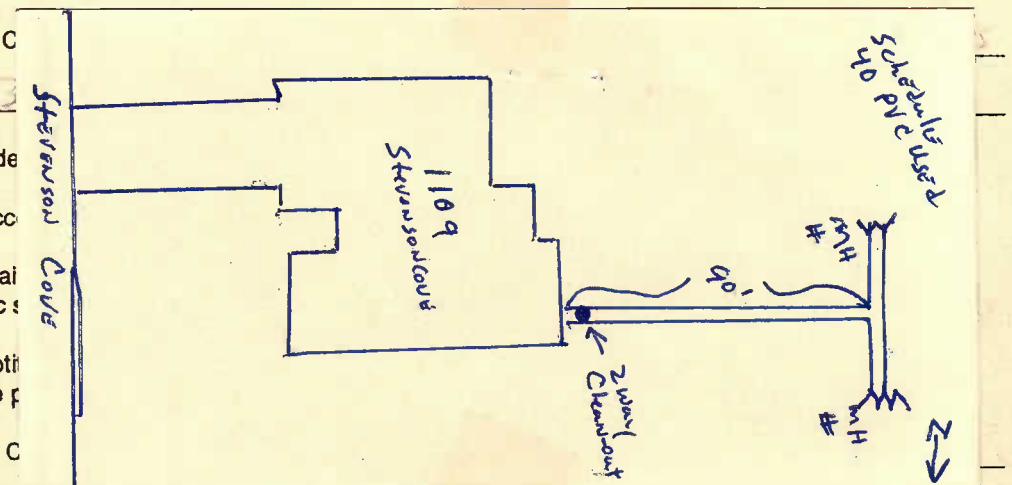

Tap Charge

\$

Inspection Fee

\$

Street Cut

\$

Receipt No. _____

Receipt No. _____

Receipt No. _____

APPLICANT

Signed _____

- ☐
- Plumbing Contractor
-
- ☐
- General Contract
-
- ☐
- Owner (Address _____)

APPROVED

Jacksonville Wastewater Utility

By: _____ Date: _____

Inspected
3-29-06