



No. 98 - 166

JACKSONVILLE WASTEWATER UTILITY

248 Cloverdale Road • P.O. Box 69
Jacksonville, AR 72078-0069
982-0581

RESIDENTIAL OR COMMERCIAL BUILDING SEWER CONNECTION PERMIT

Street Address 1116 Stone Street

Legal Description _____

Facility to be connected to sewer:

Single Family Residence X *Multi-family Residential _____ Units _____

*Commercial Installation _____ Description: Kept

Water Meter (s) Size 5/8

* Commercial installations, and multi-family installations of more than 4 dwelling units must be accompanied by a site plan showing the proposed building sewer.

Sewer line installation by AAA Plumbing 9850360

Address PO Box 38 Jax AR 72078

General

Address

In con

1. To

2. To
pui

3. To
to

Fees:

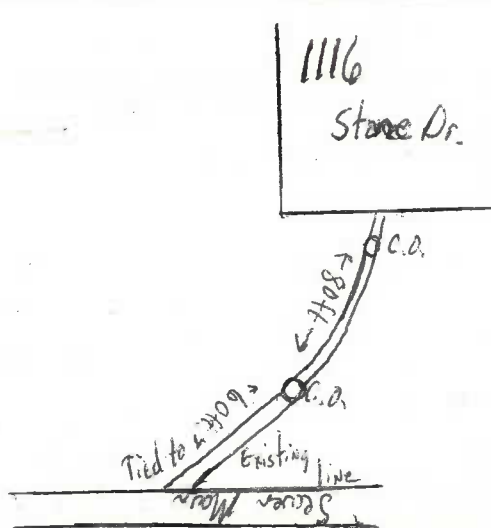

Inspection Fee \$ 6.00

Receipt No. 11517

Total Fees \$ _____

APPLICANT

Signed per phone Invoice

☒ Plumbing Contractor

☐ General Contract

☐ Owner (Address _____)

APPROVED

Jacksonville Wastewater Utility

By: Loren Stivers Date: 6-16-98