



No. 03-0212

JACKSONVILLE WASTEWATER UTILITY

248 Cloverdale Road • P.O. Box 69
Jacksonville, AR 72078-0069
982-0581

RESIDENTIAL OR COMMERCIAL BUILDING SEWER CONNECTION PERMIT

Street Address

1121 & 1123 Ruthanne Dr.

Legal Description

Kinnfield Lot # 33 & 34

Facility to be connected to sewer:

Single Family Residence

*Multi-family Residential

Units

*Commercial Installation

Description:

Water Meter (s) Size

5/8"

* Commercial installations, and multi-family installations of more than 4 dwelling units must be accompanied by a site plan showing the proposed building sewer.

Sewer line installation by

Joe's Plumbing

Address

General Contractor

Address

In consideration of

1. To accept a
2. To maintain public sewer
3. To notify the to the public

Fees: Connection

Tap Charge

\$

Inspection Fee

\$

Street Cut

\$

Receipt No.

Receipt No.

Receipt No.

APPLICANT

Signed

☐ Plumbing Contractor☐ General Contractor☐ Owner (Address

APPROVED

Jacksonville Wastewater Utility

By:

Date:

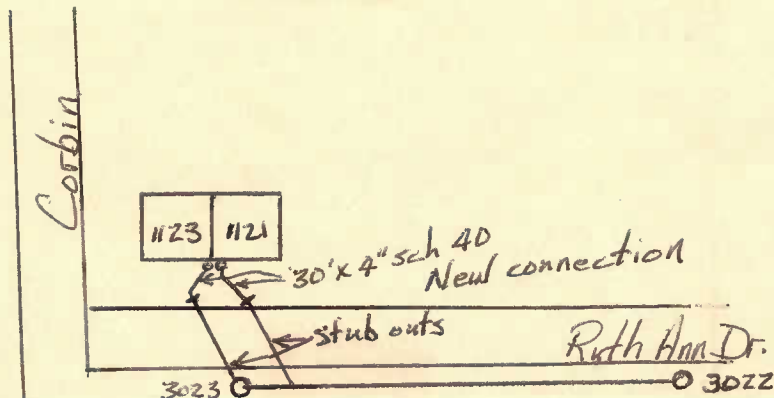

8-27-03