



JACKSONVILLE WASTEWATER UTILITY
248 Cloverdale Rd.
Jacksonville, AR 72076
501-982-0581

No. 07- 0296

RESIDENTIAL OR COMMERCIAL BUILDING SEWER CONNECTION PERMIT

Street Address 114 Marble Dr.

Legal Description Lot 8 Stoneridge Subdivision

Facility to be connected to sewer:

Single Family Residence X *Multi-family Residential Units

*Commercial Installation Description:

Water Meter (s) Size

* Commercial installations, and multi-family installations of more than 4 dwelling units must be accompanied by a site plan showing the proposed building sewer.

Sewer line installation by Fletcher Construction Mulligan Plow

Address

General Contractor

Address

In consideration of

1. To accept
2. To maintain public sewer 1-57M HW
3. To notify to the public 2-57M HW

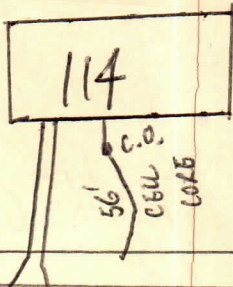

Fees:	Connection Fee	\$ <u>75.00</u>	<u>10-31-07</u>	Receipt No. <u>1103</u>
	Tap Charge	\$ <u> </u>		Receipt No. <u> </u>
	Inspection Fee	\$ <u>12.00</u>	<u>2-8-08</u>	Receipt No. <u>on Acct</u>
	Street Cut	\$ <u> </u>		Receipt No. <u> </u>

APPLICANT
Signed

- ☐ Plumbing Contractor
☐ General Contract
☐ Owner (Address)

APPROVED
Jacksonville Wastewater Utility

By: Date: 26 Oct-07

Completed
2-8-08