



JACKSONVILLE WASTEWATER UTILITY

248 Cloverdale Rd.
Jacksonville, AR 72076
501-982-0581

No. 08- 0037

RESIDENTIAL OR COMMERCIAL BUILDING SEWER CONNECTION PERMIT

Street Address 114 Seneca

Legal Description _____

Facility to be connected to sewer:

Single Family Residence ☒ *Multi-family Residential Service Line Units 1

*Commercial Installation _____ Description: Spot Repair

Water Meter (s) Size 5/8"

* Commercial installations, and multi-family installations of more than 4 dwelling units must be accompanied by a site plan showing the proposed building sewer.

Sewer line installation by JWU

Address _____

General Cor _____

Address _____

In considera _____

1. To accep _____

2. To mainta public sev _____

3. To notify 1 to the put _____

Fees: Con _____

Tap Charge \$ _____

Inspection Fee \$ 0

Street Cut \$ _____

Receipt No. _____

Receipt No. No charge

Receipt No. _____

APPLICANT

Signed _____

☐ Plumbing Contractor

☐ General Contract

☐ Owner (Address _____)

APPROVED

Jacksonville Wastewater Utility

By: Jessica Kendrick Date: 3-13-08

Inspected
3-13-08



JACKSONVILLE WASTEWATER UTILITY
248 Cloverdale Rd.
Jacksonville, AR 72076
501-982-0581

No. 23- 0005

RESIDENTIAL OR COMMERCIAL BUILDING SEWER CONNECTION PERMIT

Street Address 114 Seneca Place

Legal Description _____

Facility to be connected to sewer:

Single Family Residence ☒ *Multi-family Residential _____ Units _____

*Commercial Installation _____ Description: Repair

Water Meter (s) Size 5/8

* Commercial installations, and multi-family installations of more than 4 dwelling units must be accompanied by a site plan showing the proposed building sewer.

Sewer line installation by Chad w/ Rotor Rooter - Scruggins

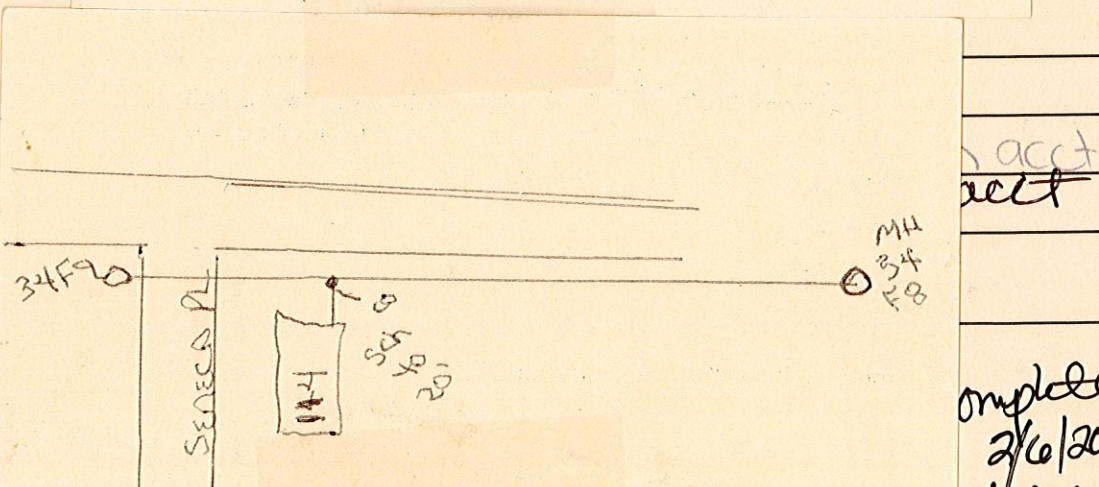
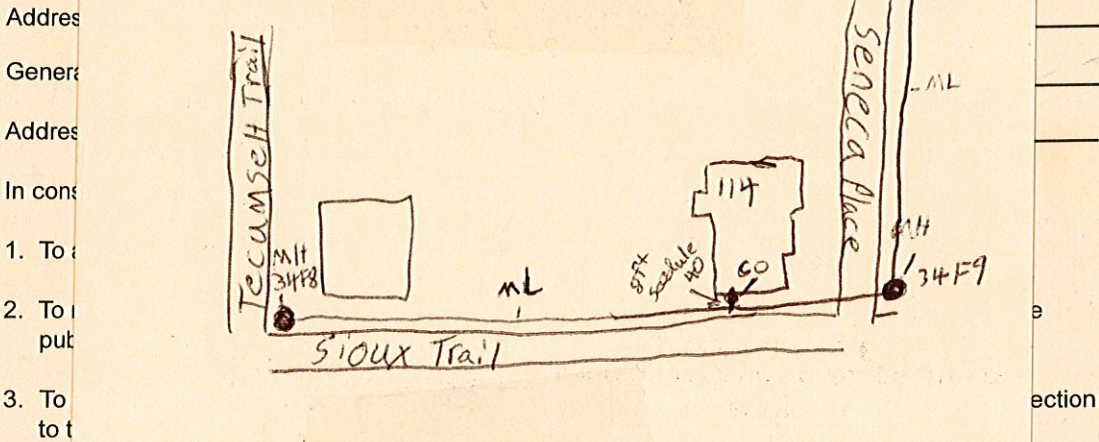

APPROVED
Jacksonville Wastewater Utility

By: [Signature] Date: 2/3/2023

complete
2/6/2023
Ariel
2/15/2023
complete