



JACKSONVILLE WASTEWATER UTILITY

248 Cloverdale Rd.
Jacksonville, AR 72076
501-982-0581

No. 08-0143

RESIDENTIAL OR COMMERCIAL BUILDING SEWER CONNECTION PERMIT

Street Address 115 Galloway Circle

Legal Description _____

Facility to be connected to sewer:

Single Family Residence ☒ *Multi-family Residential _____ Units _____

*Commercial Installation _____ Description: 90" Box Replacement / Repair

Water Meter (s) Size 1 1/2"

* Commercial installations, and multi-family installations of more than 4 dwelling units must be accompanied by a site plan showing the proposed building sewer.

Sewer line installation by Precision Plumbing (501-741-4102)

Address _____

General _____

Address _____

In consideration of _____

1. To acquire _____

2. To maintain _____ public _____

3. To not _____ to the _____

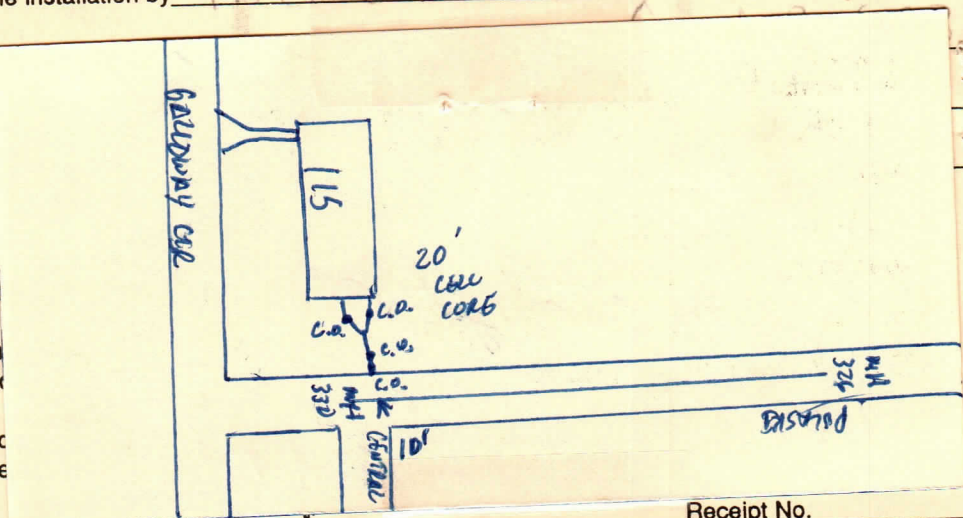

Fees: Connection Fee \$ _____

Tap Charge \$ _____

Inspection Fee \$ 25.00

Street Cut \$ 1050.00

Receipt No. _____

Receipt No. _____

Receipt No. 389

Receipt No. 8041

APPLICANT

Signed _____

☐ Plumbing Contractor

☐ General Contract

☐ Owner (Address _____)

APPROVED
Jacksonville Wastewater Utility

By: [Signature] Date: 11/7/08

Completed
11-10-08