



# JACKSONVILLE WASTEWATER UTILITY

248 Cloverdale Rd.  
Jacksonville, AR 72076  
501-982-0581

No. 10-0000180

## RESIDENTIAL OR COMMERCIAL BUILDING SEWER CONNECTION PERMIT

Street Address 116 N. Ave

Legal Description \_\_\_\_\_

Facility to be connected to sewer:

Single Family Residence ☒ \*Multi-family Residential \_\_\_\_\_ Units \_\_\_\_\_

\*Commercial Installation \_\_\_\_\_ Description: Replacement

Water Meter (s) Size 5/8 SCD

\* Commercial installations, and multi-family installations of more than 4 dwelling units must be accompanied by a site plan showing the proposed building sewer.

Sewer line installation by Anderson Plumbing & Heating

Address \_\_\_\_\_

General \_\_\_\_\_

Address 319 44 317 44

In consid \_\_\_\_\_

1. To ac \_\_\_\_\_

2. To m \_\_\_\_\_  
public \_\_\_\_\_

3. To n \_\_\_\_\_  
to the \_\_\_\_\_

Fees: \_\_\_\_\_

\_\_\_\_\_

\_\_\_\_\_

\_\_\_\_\_

APPLIC \_\_\_\_\_

Signed \_\_\_\_\_

☐ General Contract

☐ Owner (Address \_\_\_\_\_)

APPROVED \_\_\_\_\_

Jacksonville Wastewater Utility

By: Debbie Black Date: 10/1/10

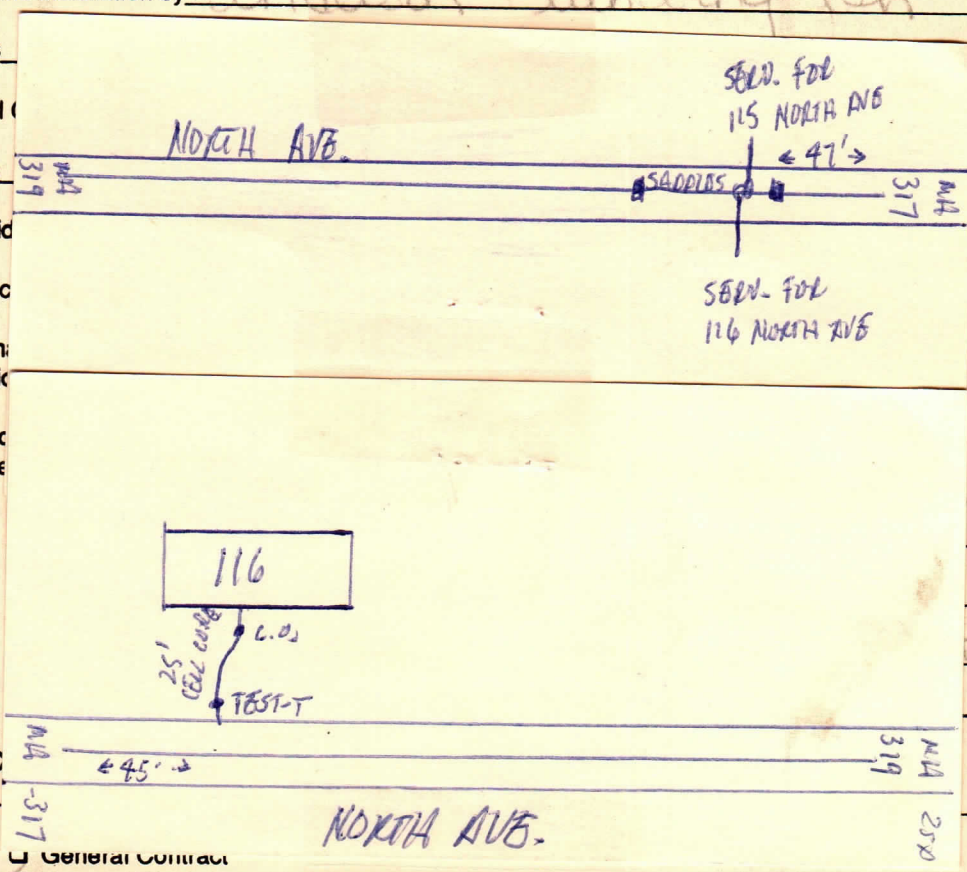

10/1/10 complete  
10/12/10 street cut final