



# JACKSONVILLE WASTEWATER UTILITY

248 Cloverdale Rd.  
Jacksonville, AR 72076  
501-982-0581

No. 06- 0210

## RESIDENTIAL OR COMMERCIAL BUILDING SEWER CONNECTION PERMIT

Street Address 119 Joiner

Legal Description \_\_\_\_\_

Facility to be connected to sewer:

Single Family Residence ☒ \*Multi-family Residential \_\_\_\_\_ Units \_\_\_\_\_

\*Commercial Installation \_\_\_\_\_ Description: Clean out

Water Meter (s) Size 5/8"

\* Commercial installations, and multi-family installations of more than 4 dwelling units must be accompanied by a site plan showing the proposed building sewer.

Sewer line installation by AAA Plumbing

Address \_\_\_\_\_

General \_\_\_\_\_

Address \_\_\_\_\_

In consid \_\_\_\_\_

1. To acc \_\_\_\_\_

2. To ma public \_\_\_\_\_

3. To not to the \_\_\_\_\_

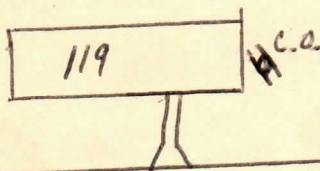

JOINER AVE

Fees: Connection Fee \$ \_\_\_\_\_ Receipt No. \_\_\_\_\_

Tap Charge \$ \_\_\_\_\_ Receipt No. \_\_\_\_\_

Inspection Fee \$ 12.00 Receipt No. on file

Street Cut \$ \_\_\_\_\_ Receipt No. \_\_\_\_\_

### APPLICANT

Signed Signature on file

☐ Plumbing Contractor

☐ General Contract

☐ Owner (Address \_\_\_\_\_)

### APPROVED

Jacksonville Wastewater Utility

By: Jessica Kendrick Date: 10-27-06

Inspected  
10-27-06

10-0000304



**JACKSONVILLE WASTEWATER UTILITY**  
248 Cloverdale Rd.  
Jacksonville, AR 72076  
501-982-0581

**RESIDENTIAL OR COMMERCIAL BUILDING SEWER CONNECTION PERMIT**

**Street Address**

### Legal Description

Facility to be connected to sewer:

Single Family Residence \_\_\_\_\_ \*Multi-family Residential \_\_\_\_\_ Units \_\_\_\_\_

\*Commercial Installation \_\_\_\_\_ Description: Replaced 2 doors

Water Meter (s) Size \_\_\_\_\_

Water Meter (s) Size \_\_\_\_\_

\* Commercial installations, and multi-family installations of more than 4 dwelling units must be accompanied by a site plan showing the proposed building sewer.

### Sewer line installation by

### Address

## General Con

**Address**

In consideration

1. To accep

2. To maintain public service

3. To notify  
to the pul

Fees: Con

Tap

Ins

Str

**APPLICAN**

**Signed**

三

**APPROVED**  
**Jacksonville Wastewater Utility**

By:

Date:



Upstream Manhole # 119 Joiner  
Downstream Manhole # mainline

Technician: Warren M.  
Date: 10/15/10

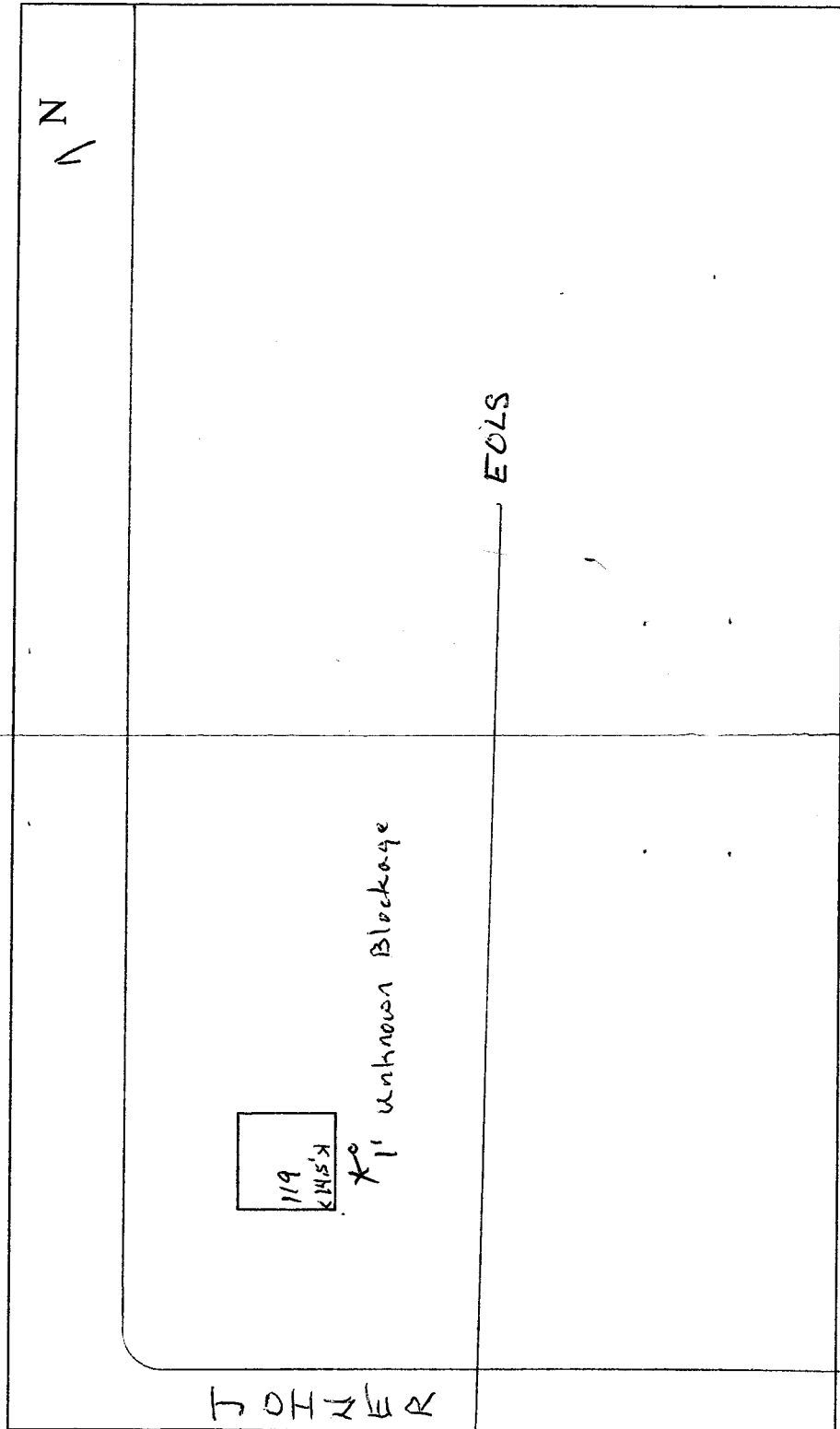

JWWU -- DEFECT SKETCH