



JACKSONVILLE WASTEWATER UTILITY

248 Cloverdale Rd.
Jacksonville, AR 72076
501-982-0581

No. 07-

0160

RESIDENTIAL OR COMMERCIAL BUILDING SEWER CONNE

Street Address #6-3 Red Fox

Legal Description _____

Facility to be connected to sewer:

Single Family Residence ☒ *Multi-family Residential _____ Units _____

*Commercial Installation _____ Description: New Connection

Water Meter (s) Size 5/8"

* Commercial installations, and multi-family installations of more than 4 dwelling units must be accompanied by a site plan showing the proposed building sewer.

Sewer line installation by Harder Plumbing

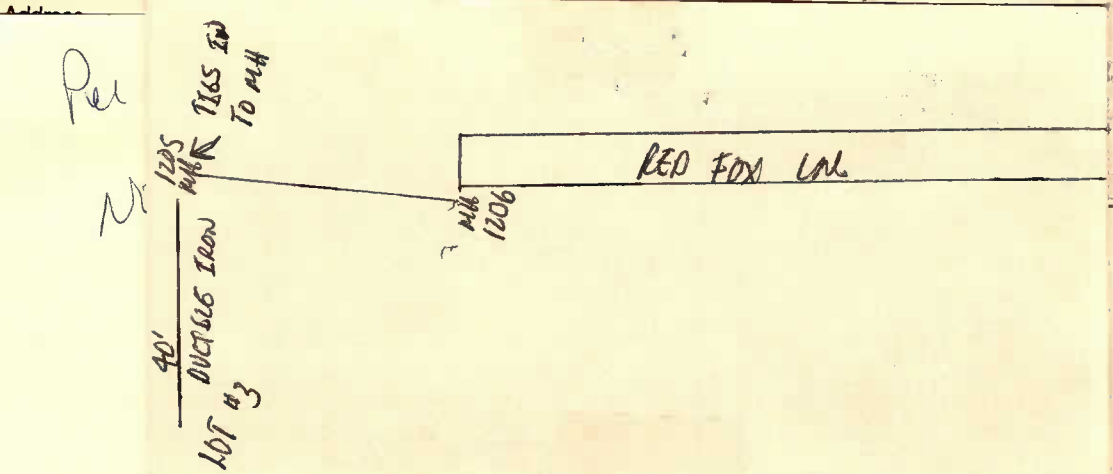

Inspection Fee \$ 12.00

Street Cut \$ _____

Receipt No. 1140

Receipt No. 1139

Receipt No. 1139

Receipt No. _____

APPLICANT

Signed Paul Davis

☐ Plumbing Contractor

☐ General Contract

☐ Owner (Address _____)

APPROVED

Jacksonville Wastewater Utility

By: James Kendrick Date: 11-26-07

Inspected

By: [Signature] Date: 11/30/00