



No. 87- 00100

JACKSONVILLE WASTEWATER UTILITY

RESIDENTIAL OR COMMERCIAL BUILDING SEWER CONNECTION PERMIT

Street Address 1204 Oakhurst

Legal Description _____

Facility to be connected to sewer:

Single Family Residence *Multi-family Residential Units

*Commercial Installation Description: 14' diameter

Water Meter (s) size 54"

*Commerical installations, and multi-family installations of more than 4 dwelling units must be accompanied by a site plan showing the proposed building sewer.

Sewer line installation by Brith's Rbg

Address _____

General _____

Address _____

In cons _____

1. To _____

2. To _____

3. To _____

and _____

cov _____

Fees: _____

Tap Charge \$ _____

Receipt No. _____

Inspection Fee \$ 6.00

Receipt No. 280210118

Total Fees \$ 6.00

APPLICANT _____

Signed _____

☐ Plumbing Contractor

☐ General Contract

☐ Owner (Address _____)

APPROVED
Jacksonville Wastewater Utility

By: [Signature]

Date: 6/11/87

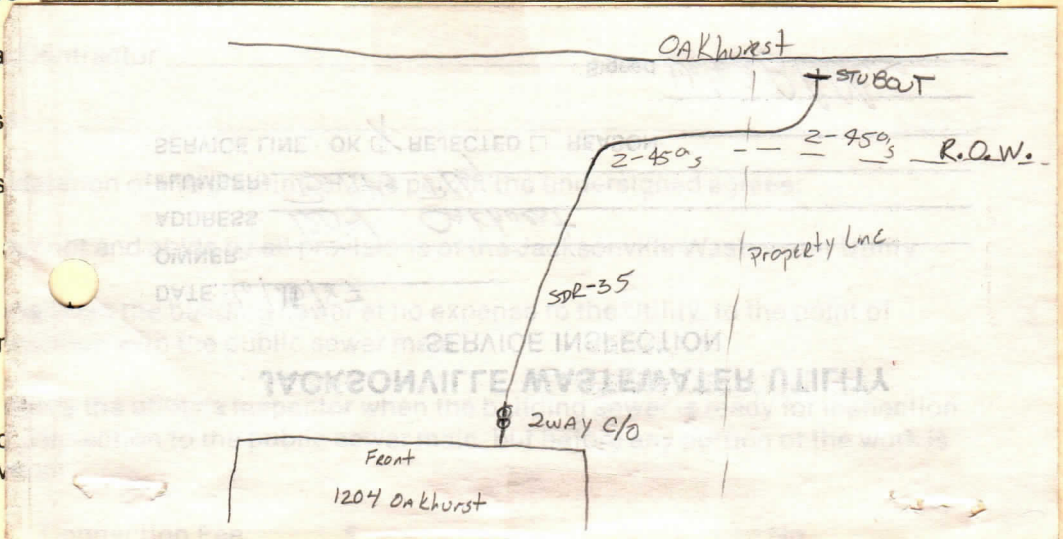



JACKSONVILLE WASTEWATER UTILITY
248 Cloverdale Rd.
Jacksonville, AR 72076
501-982-0581

No. 10-0000183

RESIDENTIAL OR COMMERCIAL BUILDING SEWER CONNECTION PERMIT

Street Address 1204 Oakhurst Drive

Legal Description _____

Facility to be connected to sewer:

Single Family Residence ☒ *Multi-family Residential _____ Units _____

*Commercial Installation _____ Description: Replacement

Water Meter (s) Size 5/8" SLD

* Commercial installations, and multi-family installations of more than 4 dwelling units must be accompanied by a site plan showing the proposed building sewer.

Sewer line installation by 24 Drain +

Address Ken Williams Plumbing MP 501-941-8781

General

Address

In consid

1. To ac

2. To ma
public

3. To no
to the

Fees:

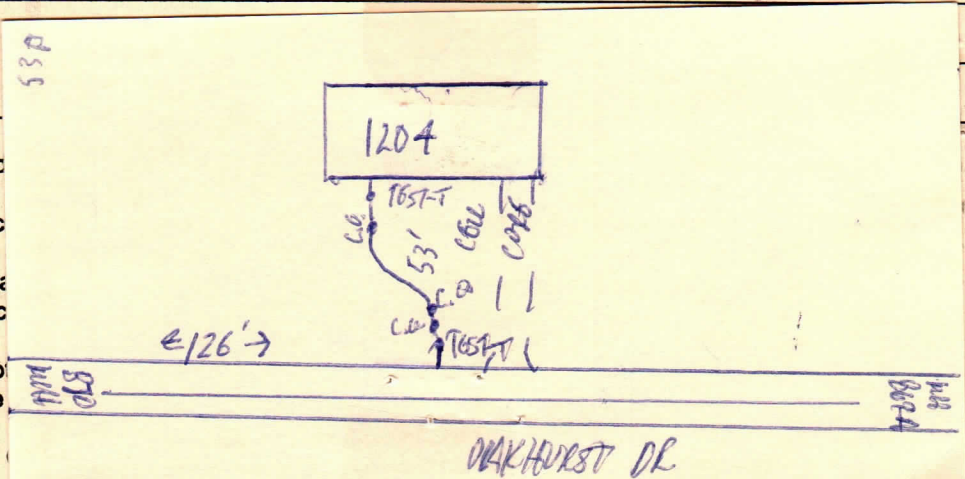

Tap Charge \$ _____

Receipt No. _____

Inspection Fee \$ 25.00

Receipt No. 240997

Street Cut \$ _____

Receipt No. _____

APPLICANT

Signed Rust Kelley

☐ Plumbing Contractor

☐ General Contract

☐ Owner (Address _____)

APPROVED

Jacksonville Wastewater Utility

By: Jessica Kludick Date: 10/7/10

10/14/10
Complete