



No. 13- 0384

JACKSONVILLE WASTEWATER UTILITY

248 Cloverdale Rd.
Jacksonville, AR 72076
501-982-0581

RESIDENTIAL OR COMMERCIAL BUILDING SEWER CONNECTION PERMIT

Street Address 1225 Foxwood Drive

Legal Description Lot C, Foxwood Ph. XI

Facility to be connected to sewer:

Single Family Residence _____ *Multi-family Residential _____ Units _____

*Commercial Installation _____ Description: New Connection

Water Meter (s) Size 3/8

* Commercial installations, and multi-family installations of more than 4 dwelling units must be accompanied by a site plan showing the proposed building sewer.

Sewer line installation by Jeff Brewer Plumbing

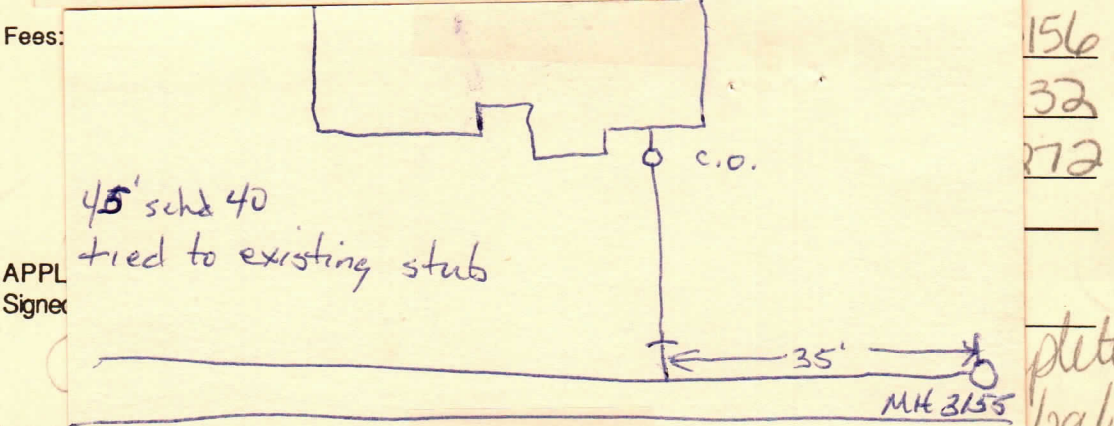
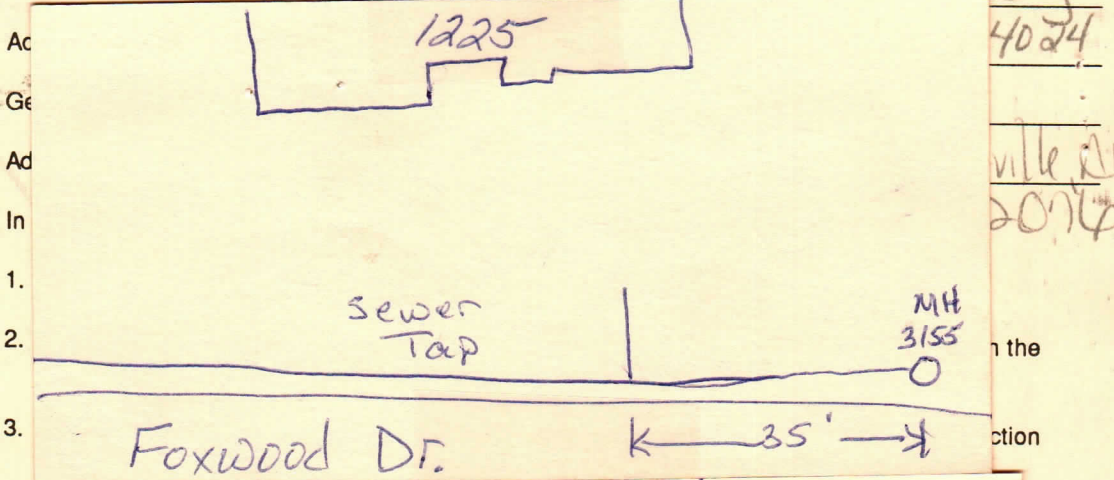

APPL 7-20 Foxwood Dr.
Signer Westpointe Dr.
Jacksonville, AR 72076

By: J. Martin Date: 4.23.13