



No. 98 - 183

JACKSONVILLE WASTEWATER UTILITY

248 Cloverdale Road • P.O. Box 69
Jacksonville, AR 72078-0069
982-0581

RESIDENTIAL OR COMMERCIAL BUILDING SEWER CONNECTION PERMIT

Street Address 1242 Commons DriveLegal Description Lot 19 Jamestown Sub

Facility to be connected to sewer:

Single Family Residence ☒ *Multi-family Residential _____ Units _____

*Commercial Installation _____ Description: _____

Water Meter (s) Size 5/8

* Commercial installations, and multi-family installations of more than 4 dwelling units must be accompanied by a site plan showing the proposed building sewer.

Sewer line installation by Harden Plmby

Diagram showing a building footprint labeled "1242 Commons Dr." connected to a manhole (MH) via a sewer line. The line is labeled "Backflow Preventer" and "Has two-way access". The distance from the building to the manhole is marked as "60ft".

Address labels on the left: Add, Ger, Add, In c, 1., 2., 3., Fee.

Tap Charge \$ _____

Receipt No. _____

Inspection Fee \$ 6.007-21-98 Receipt No. 4633Total Fees \$ 75.00

APPLICANT

Signed Rick and B Jones☐ Plumbing Contractor☐ General Contract☐ Owner (Address _____)

APPROVED

Jacksonville Wastewater Utility

By: Lisa M. Hawkins Date: 6-18-98



JACKSONVILLE WASTEWATER UTILITY
248 Cloverdale Rd.
Jacksonville, AR 72076
501-982-0581

No. 13- 0179

RESIDENTIAL OR COMMERCIAL BUILDING SEWER CONNECTION PERMIT

Street Address 1242 Commons Drive

Legal Description _____

Facility to be connected to sewer:

Single Family Residence _____ *Multi-family Residential _____ Units _____

*Commercial Installation _____ Description: Replacement

Water Meter (s) Size 5/8"

* Commercial installations, and multi-family installations of more than 4 dwelling units must be accompanied by a site plan showing the proposed building sewer.

Sewer line installation by Ken's Express Plumbing Ken 416-6079

Address _____

General _____

Address _____

In cons _____

1. To _____

2. To _____

3. To _____

to th _____

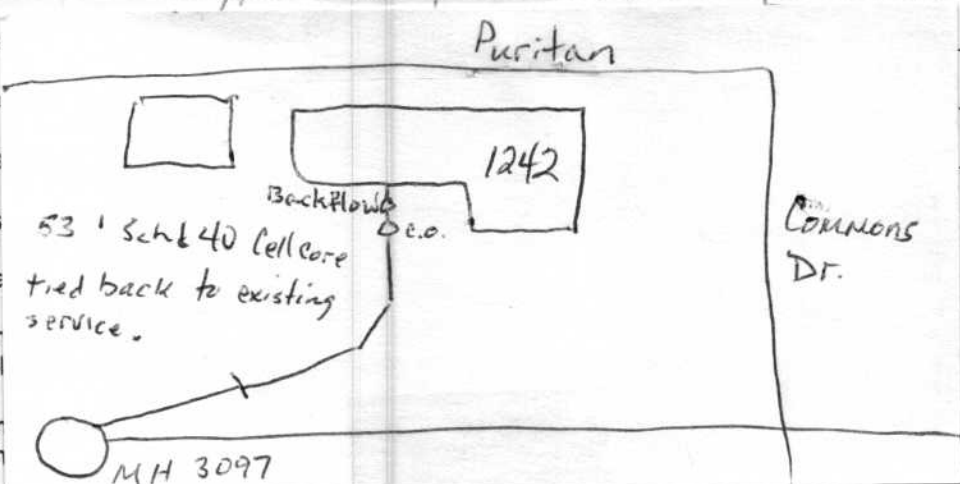

Fees: Connection Fee \$ _____

Receipt No. _____

Tap Charge \$ _____

Receipt No. _____

Inspection Fee \$ 25.00

Receipt No. 750259

Street Cut \$ _____

Receipt No. _____

APPLICANT

Signed Donnell Dayle Jr.

☐ Plumbing Contractor

☐ General Contract

☐ Owner (Address _____)

APPROVED

Jacksonville Wastewater Utility

By: Jessica Kendrick

Date: 7/23/13

Complete
7/23/13