



JACKSONVILLE WASTEWATER UTILITY

248 Cloverdale Rd.
Jacksonville, AR 72076
501-982-0581

No. 06- 0170

RESIDENTIAL OR COMMERCIAL BUILDING SEWER CONNECTION PERMIT

Street Address 125 Fox Dell Circle

Legal Description _____

Facility to be connected to sewer:

Single Family Residence ☒ *Multi-family Residential _____ Units _____

Commercial Installation _____ Description: Replacement

Water Meter (s) Size 5/8"

* Commercial installations, and multi-family installations of more than 4 dwelling units must be accompanied by a site plan showing the proposed building sewer.

Sewer line installation by AAA Plumbing

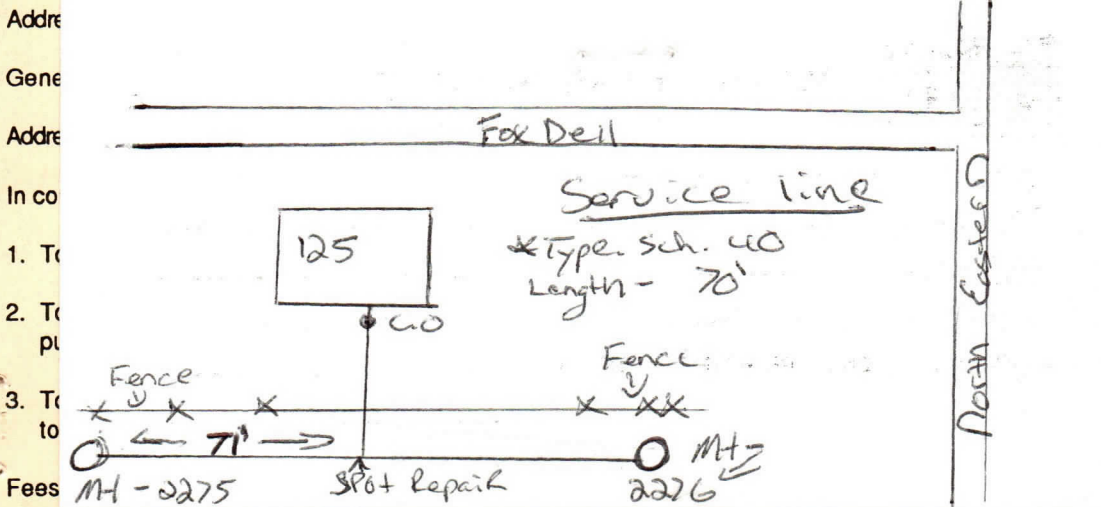

Tap Charge \$ _____

Receipt No. _____

Inspection Fee Partial \$ 12.00 4/26 6/26

Receipt No. on Acct

Street Cut \$ _____

Receipt No. on Acct

APPLICANT

Signed Signature on file

☐ Plumbing Contractor

☐ General Contract

☐ Owner (Address _____)

APPROVED

Jacksonville Wastewater Utility

By: Jessica Kendrick Date: 6/26/06

Paul Partial 6/26/06

Paul Final 6/27/06

Paul Final 6-27-06