



JACKSONVILLE WASTEWATER UTILITY

248 Cloverdale Road • P.O. Box 69  
Jacksonville, AR 72076  
982-0581

No. 90-

000013

RESIDENTIAL OR COMMERCIAL BUILDING SEWER CONNECTION PERMIT

Street Address 128 Pike

Legal Description \_\_\_\_\_

Facility to be connected to sewer:

Single Family Residence ☒ \*Multi-family Residential \_\_\_\_\_ Units \_\_\_\_\_

\*Commercial Installation \_\_\_\_\_ Description: Replacement

Water Meter (s) Size 5/8"

\* Commercial installations, and multi-family installations of more than 4 dwelling units must be accompanied by a site plan showing the proposed building sewer.

Sewer line installation by Circle M

Address \_\_\_\_\_

General

Address \_\_\_\_\_

In consid

1. To ac

2. To m  
public

3. To ne  
to the

Fees:

Inspection Fee \$ 6.00

Receipt No. 90-0029 1/25/90

Total Fees \$ 6.00

APPLICANT

Signed John Hughes

☐ Plumbing Contractor

☐ General Contract

☐ Owner (Address \_\_\_\_\_)

APPROVED

Jacksonville Wastewater Utility

By: John Hughes Date: 1-23-90



NO. 02- 000168

# JACKSONVILLE WASTEWATER UTILITY

248 Cloverdale Road · P.O. Box 69  
Jacksonville, AR 72078-0069  
982-0581

## RESIDENTIAL OR COMMERCIAL BUILDING SEWER CONNECTION PERMIT

Street Address 128 Pike Avenue

Legal Description \_\_\_\_\_

Facility to be connected to sewer:

Single Family Residence \_\_\_\_\_ \*Multi-family Residential \_\_\_\_\_ Units \_\_\_\_\_

\*Commercial Installation \_\_\_\_\_ Description: Repair

Water Meter (s) Size \_\_\_\_\_

\* Commercial installations, and multi-family installations of more than 4 dwelling units must be accompanied by a site plan showing the proposed building sewer.

Sewer line installation by Jacksonville Wastewater Utility

Address \_\_\_\_\_

General \_\_\_\_\_

Address \_\_\_\_\_

In connection with \_\_\_\_\_

1. To \_\_\_\_\_

2. To \_\_\_\_\_  
pub \_\_\_\_\_

3. To \_\_\_\_\_  
to the \_\_\_\_\_

Fees: \_\_\_\_\_

Inspection Fee \$ \_\_\_\_\_ Receipt No. \_\_\_\_\_

Street Cut \$ \_\_\_\_\_ Receipt No. \_\_\_\_\_

### APPLICANT

Signed \_\_\_\_\_

☐ Plumbing Contractor

☐ General Contract

☐ Owner (Address \_\_\_\_\_)

### APPROVED

Jacksonville Wastewater Utility

By: [Signature] Date: 17 August 02

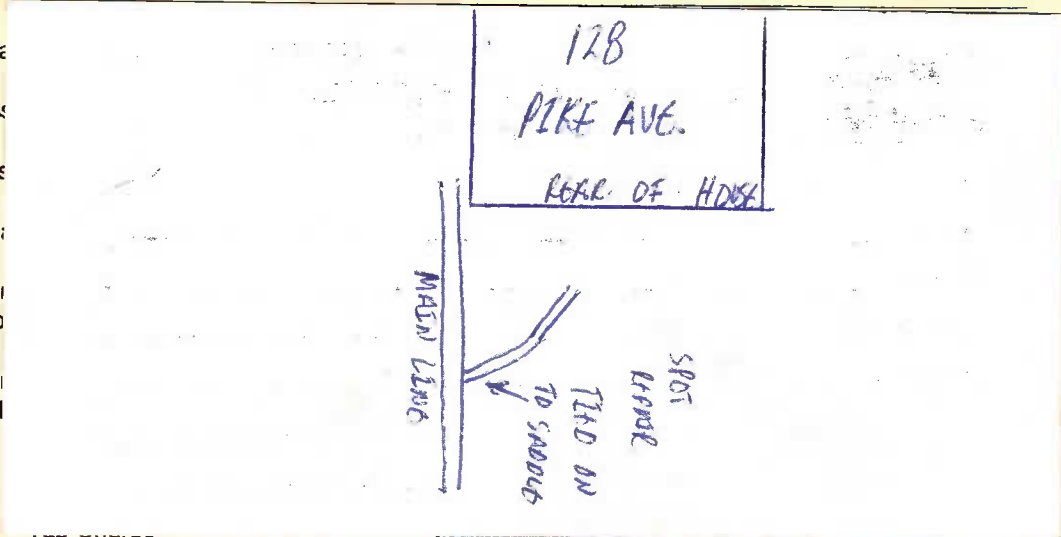

**248 Cloverdale Rd.  
Jacksonville, AR 72076  
501-982-0581**

No. 10-000281

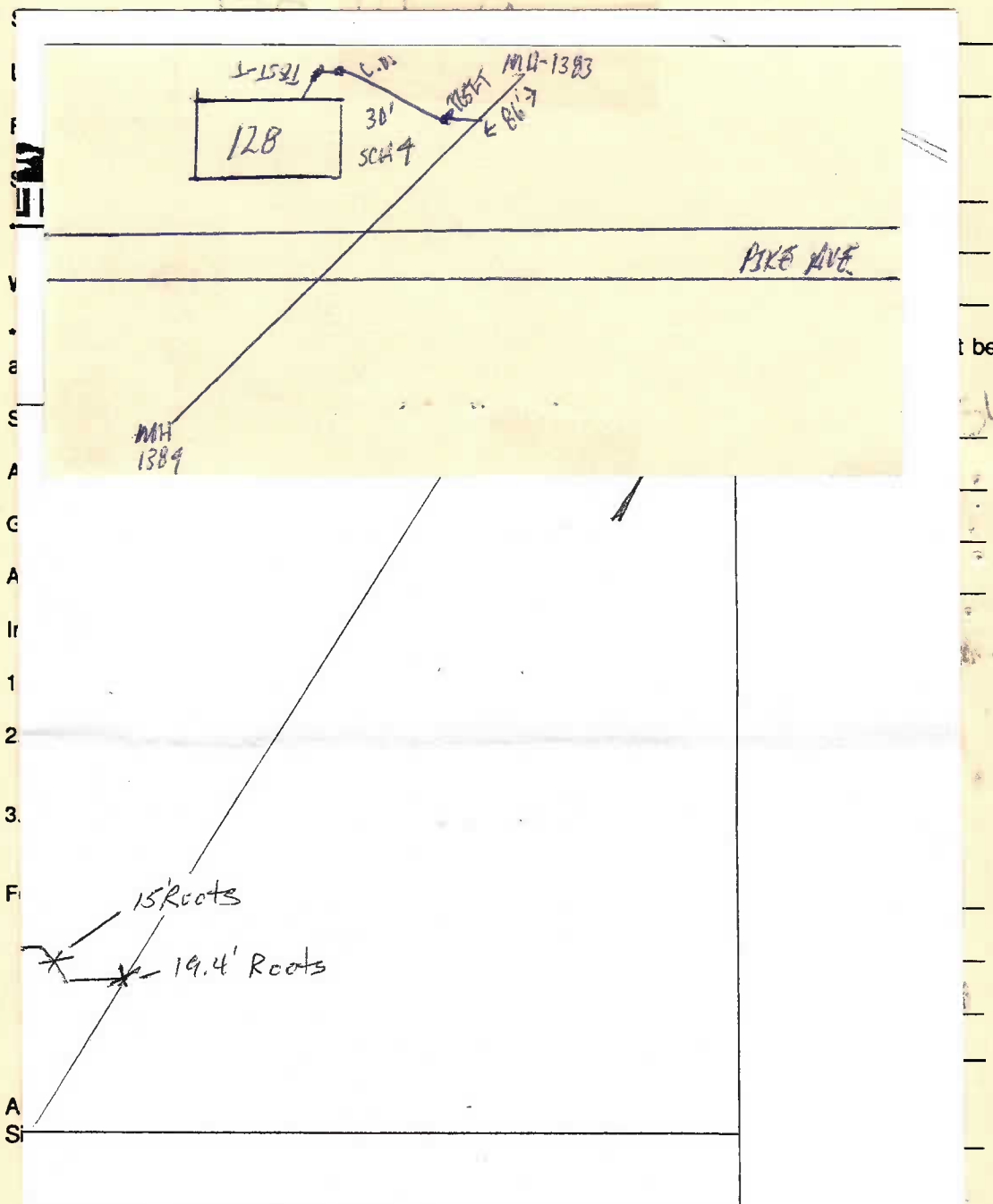
**RESIDENTIAL OR COMMERCIAL BUILDING SEWER CONNECTION PERMIT**

## EFFECT SKETCH