



No. 01098

## JACKSONVILLE WASTEWATER UTILITY

248 Cloverdale Road • P.O. Box 69  
Jacksonville, AR 72078-0069  
982-0581

## RESIDENTIAL OR COMMERCIAL BUILDING SEWER CONNECTION PERMIT

Street Address 1304 High MeadowsLegal Description Lot 74 Parkview Subd.

Facility to be connected to sewer:

Single Family Residence ☒ \*Multi-family Residential \_\_\_\_\_ Units \_\_\_\_\_

\*Commercial Installation \_\_\_\_\_ Description: \_\_\_\_\_

Water Meter (s) Size 5/8

\* Commercial installations, and multi-family installations of more than 4 dwelling units must be accompanied by a site plan showing the proposed building sewer.

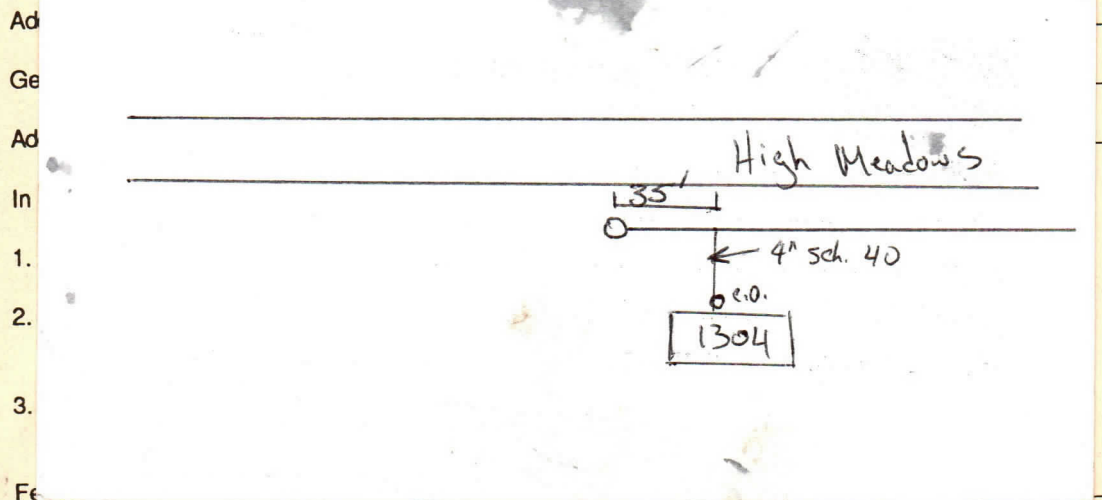
Sewer line installation by Harden Plumbing

Tap Charge \$ \_\_\_\_\_

Receipt No. \_\_\_\_\_

Inspection Fee \$ 6.00 6/27/01Receipt No. 2910Total Fees \$ 9.50

## APPLICANT

Signed [Signature]☐ Plumbing Contractor☐ General Contract☐ Owner (Address \_\_\_\_\_)

## APPROVED

Jacksonville Wastewater Utility

By: Melanie Green Date: 4/19/01