



NO. 02- 000129

JACKSONVILLE WASTEWATER UTILITY

248 Cloverdale Road · P.O. Box 69
Jacksonville, AR 72078-0069
982-0581

RESIDENTIAL OR COMMERCIAL BUILDING SEWER CONNECTION PERMIT

Street Address 1309 Riverwood Drive

Legal Description Lot 29 Parkway Subd

Facility to be connected to sewer:

Single Family Residence ☒ *Multi-family Residential _____ Units _____

*Commercial Installation _____ Description: _____

Water Meter (s) Size 3/8

* Commercial installations, and multi-family installations of more than 4 dwelling units must be accompanied by a site plan showing the proposed building sewer.

Sewer line Installation by Abshire Plumbing

Address _____

General _____

Address _____

In consid _____

1. To ac _____

2. To ma _____
public _____

3. To no _____
to the _____

Fees: _____

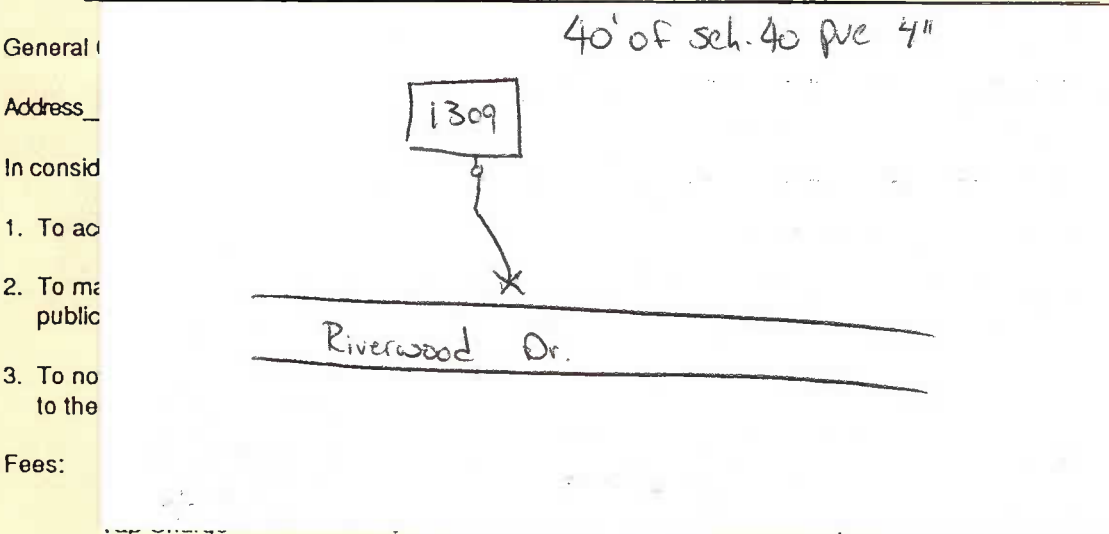

Inspection Fee 12-09-02 \$ 6.00

Receipt No. 4465

Street Cut \$ _____

Receipt No. _____

APPLICANT
Signed [Signature]

☐ Plumbing Contractor

☒ General Contract

☐ Owner (Address _____)

APPROVED

Jacksonville Wastewater Utility

By: [Signature] Date: 9-4-02