



JACKSONVILLE WASTEWATER UTILITY
248 Cloverdale Rd.
Jacksonville, AR 72076
501-982-0581

No. 14- 0024

RESIDENTIAL OR COMMERCIAL BUILDING SEWER CONNECTION PERMIT

Street Address 1313 Gregory / 1401 Gregory Jville

Legal Description " "

Facility to be connected to sewer:

Single Family Residence ☒ *Multi-family Residential ☐ Units ☐

*Commercial Installation ☐ Description: Repair Capped Sewer

Water Meter (s) Size 5/8

* Commercial installations, and multi-family installations of more than 4 dwelling units must be accompanied by a site plan showing the proposed building sewer.

Sewer line installation by Jim Mullicken 681-8828

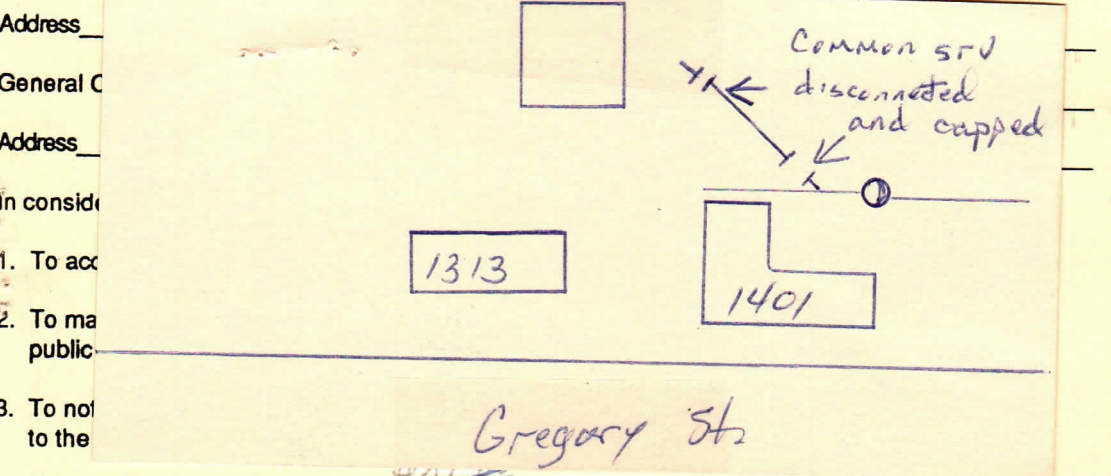

Fees:	Connection Fee	\$ <u>425.00</u>	Receipt No. _____
	Tap Charge	\$ _____	Receipt No. _____
	Inspection Fee	\$ <u>25.00</u>	Receipt No. <u>875019</u>
	Street Cut	\$ _____	Receipt No. _____

APPLICANT Signed James W. Hansen

☐ Plumbing Contractor

☐ General Contract

☐ Owner (Address 349-3105)

complete
3/10/14

APPROVED
Jacksonville Wastewater Utility

By: JoAnn White Date: 3/7/14