



No. 01076

JACKSONVILLE WASTEWATER UTILITY

248 Cloverdale Road • P.O. Box 69
Jacksonville, AR 72078-0069
982-0581

RESIDENTIAL OR COMMERCIAL BUILDING SEWER CONNECTION PERMIT

Street Address 1313 High MeadowsLegal Description Lot 83 Parkview Subd.Facility to be connected to sewer: JacksonvilleSingle Family Residence ☒ *Multi-family Residential _____ Units _____

*Commercial Installation _____ Description: _____

Water Meter (s) Size 5/8

* Commercial installations, and multi-family installations of more than 4 dwelling units must be accompanied by a site plan showing the proposed building sewer.

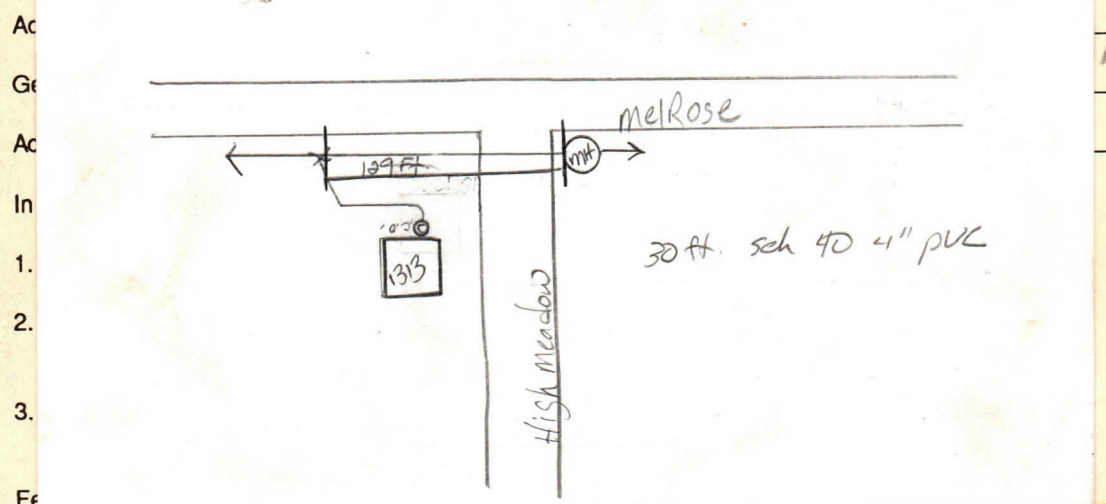
Sewer line installation by Absolute Plumbing

Tap Charge \$ _____

Receipt No. _____

Inspection Fee \$ 6.00 5/10/01Receipt No. 2977Total Fees \$ 25.00

APPLICANT

Signed Stacy Underwood☐ Plumbing Contractor☒ General Contract☐ Owner (Address _____)

APPROVED

Jacksonville Wastewater Utility

By: Melanie Green Date: 3/9/01