



No. 00

119

JACKSONVILLE WASTEWATER UTILITY

248 Cloverdale Road · P.O. Box 69
Jacksonville, AR 72078-0069
982-0581

RESIDENTIAL OR COMMERCIAL BUILDING SEWER CONNECTION PERMITStreet Address 1313 Oak ForestLegal Description 69 Parkview Subd.

Facility to be connected to sewer:

Single Family Residence ☒ *Multi-family Residential _____ Units _____

*Commercial Installation _____ Description: _____

Water Meter (s) Size 7/8

* Commercial installations, and multi-family installations of more than 4 dwelling units must be accompanied by a site plan showing the proposed building sewer.

Sewer line installation by Abshire Plumbing. Martin

Address _____

General _____

Address _____

In connection with _____

1. To _____

2. To put _____

3. To to _____

Fees: _____

Tap Charge \$ _____

Inspection Fee \$ 6.00 10-11-00

Total Fees \$ _____

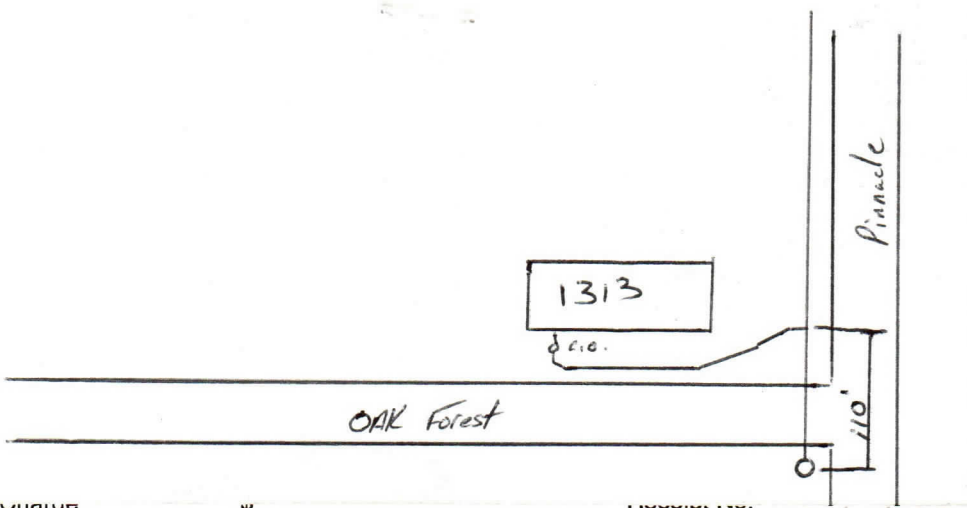
APPLICANT
Signed [Signature]☐ Plumbing Contractor☐ General Contract☐ Owner (Address _____)APPROVED
Jacksonville Wastewater UtilityBy: [Signature] Date: 10-2-00Receipt No. 2640