



No. 01196

JACKSONVILLE WASTEWATER UTILITY

248 Cloverdale Road • P.O. Box 69
Jacksonville, AR 72078-0069
982-0581

RESIDENTIAL OR COMMERCIAL BUILDING SEWER CONNECTION PERMIT

Street Address 134 North Ave

Legal Description _____

Facility to be connected to sewer:

Single Family Residence ☒ *Multi-family Residential _____ Units _____*Commercial Installation _____ Description: repairWater Meter (s) Size 5/8"

* Commercial installations, and multi-family installations of more than 4 dwelling units must be accompanied by a site plan showing the proposed building sewer.

Sewer line installation by NAA Plumbing

Add

Ge

Add

In c

1.

2.

3.

Fe

134

p.c.o.
4" she. 40 feetNorth Ave,

Tap Charge \$ _____

Receipt No. _____

Inspection Fee \$ 6.00Receipt No. 2077

Total Fees \$ _____

APPLICANT

Signed per phone☐ Plumbing Contractor☐ General Contract☐ Owner (Address _____)

APPROVED

Jacksonville Wastewater Utility

By: Bethy ReedDate: 7-19-01



JACKSONVILLE WASTEWATER UTILITY
248 Cloverdale Rd.
Jacksonville, AR 72076
501-982-0581

No. 10-

0000138

RESIDENTIAL OR COMMERCIAL BUILDING SEWER CONNECTION PERMIT

Street Address 134 North Ave

Legal Description _____

Facility to be connected to sewer:

Single Family Residence ☒ *Multi-family Residential _____ Units _____

*Commercial Installation _____ Description: replacement SD

Water Meter (s) Size _____

* Commercial installations, and multi-family installations of more than 4 dwelling units must be accompanied by a site plan showing the proposed building sewer.

Sewer line installation by Precision Plumbing

Address _____

General _____

Address _____

In connection with _____

1. To _____

2. To _____
put 3/6 3/7

3. To _____
to NORTH AVB.

Fees: _____

APPL _____
Signed _____

- ☐ General Contract
☐ Owner (Address _____)

APPROVED
Jacksonville Wastewater Utility

By: Cathy Date: 8/19/10

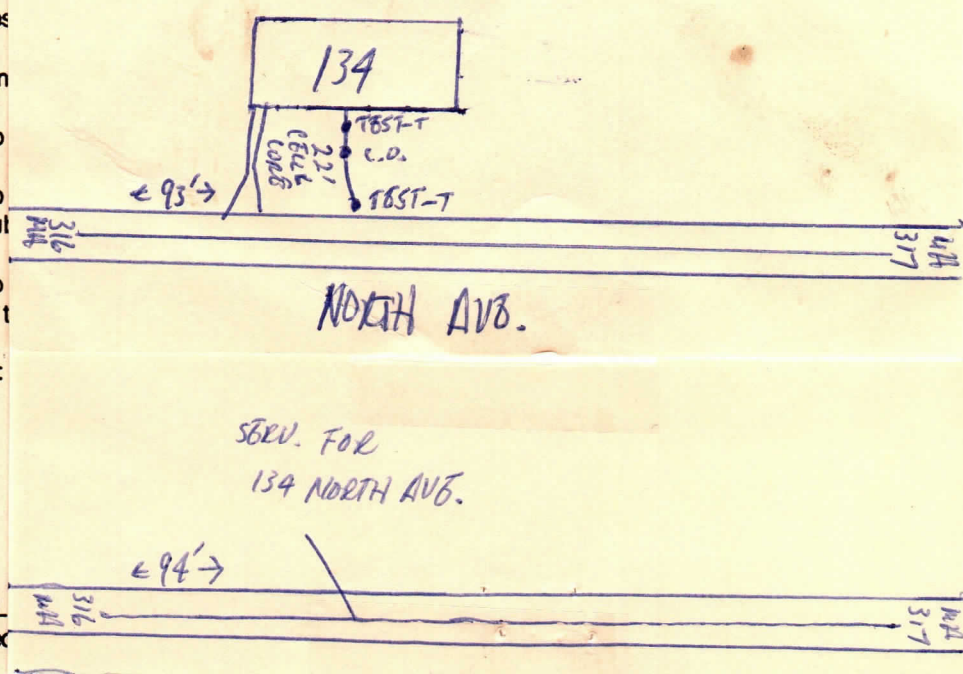

Dan
8/20/10
complete

Street cut
8/30/10
complete