



JACKSONVILLE WASTEWATER UTILITY  
248 Cloverdale Rd.  
Jacksonville, AR 72076  
501-982-0581

No. 07-0113

## RESIDENTIAL OR COMMERCIAL BUILDING SEWER CONNECTION PERMIT

Street Address 140 John Harden DR

Legal Description Tropical Smoothie Cafe Ste 29

Facility to be connected to sewer:

Single Family Residence \_\_\_\_\_ \*Multi-family Residential \_\_\_\_\_ Units \_\_\_\_\_

\*Commercial Installation ☒ Description: \_\_\_\_\_

Water Meter (s) Size 5/8"

\* Commercial installations, and multi-family installations of more than 4 dwelling units must be accompanied by a site plan showing the proposed building sewer.

Sewer line installation by Dale's Plumbing

Address \_\_\_\_\_

General Contractor \_\_\_\_\_

Address \_\_\_\_\_

In consideration of the granting of this permit the undersign

1. To accept and abide by all provisions of the Jacksonville
2. To maintain the building sewer at no expense to the Utility public sewer main.
3. To notify the utility's inspector when the building sewer is to the public sewer main, but before any portion of the w

Fees: Connection Fee \$ 75.00

Tap Charge \$ \_\_\_\_\_

Inspection Fee \$ city will

Street Cut \$ \_\_\_\_\_

APPLICANT

Signed (X)

☐ Plumbing Contractor

☐ General Contract

☒ Owner (Address Chad W. [Signature])

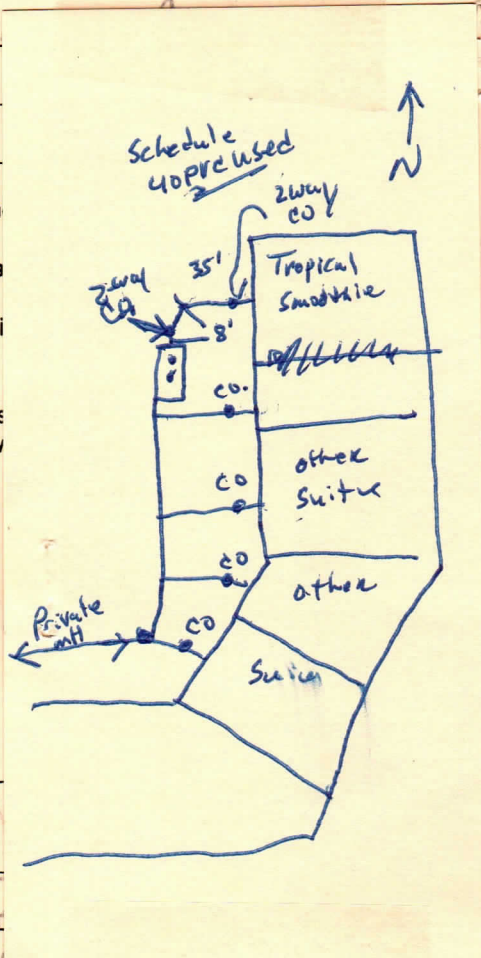

APPROVED  
Jacksonville Wastewater Utility

By: Jessica Kendrick

Date: 7-13-07



# JACKSONVILLE WASTEWATER UTILITY

248 Cloverdale Rd.  
Jacksonville, AR 72076  
501-982-0581

No. 07-0010

## RESIDENTIAL OR COMMERCIAL BUILDING SEWER CONNECTION PERMIT

Street Address 140 John Harden Drive

Legal Description Splash Bowl strip mall

Facility to be connected to sewer:

Single Family Residence \_\_\_\_\_ \*Multi-family Residential \_\_\_\_\_ Units \_\_\_\_\_

\*Commercial Installation ☒ Description: New Connection

Water Meter (s) Size \_\_\_\_\_

\* Commercial installations, and multi-family installations of more than 4 dwelling units must be accompanied by a site plan showing the proposed building sewer.

Sewer line installation by Tim Griggs Plumbing 501 580 4354 MP 402/2

Address \_\_\_\_\_

General Contractor \_\_\_\_\_

Address \_\_\_\_\_

In consideration of \_\_\_\_\_

1. To accept \_\_\_\_\_

2. To maintain public sewer \_\_\_\_\_

3. To notify \_\_\_\_\_ to the public \_\_\_\_\_

Fees: Connection \_\_\_\_\_

Tap \_\_\_\_\_

Inspection \_\_\_\_\_

Street \_\_\_\_\_

APPLICANT \_\_\_\_\_

Signed \_\_\_\_\_

☐ PL

☐ G

☐ O

APPROVED \_\_\_\_\_

Jacksonville Wastewater Utility

By: Jessica Kendrick Date: 2-9-07



### JACKSONVILLE WASTEWATER UTILITY SERVICE INSPECTION

PERMIT NO. 07-0010 019

DATE: 2-23-07

OWNER: \_\_\_\_\_

ADDRESS: 140 JOHN HARDEN DR

PLUMBER: GREGG'S PLUMBING

SERVICE LINE: OK ☒ REJECTED ☐ REASON: \_\_\_\_\_

SIGNED: Darryl Pirkus

TEBS IN TO

MA 1264

1264

1265-B

15' C.O. 50' 40'

140 - SHOPPING CENTER

JOHN HARDEN DR

turn - 2-9-07

2-23-07





No. 08- 0092

## JACKSONVILLE WASTEWATER UTILITY

248 Cloverdale Rd.  
Jacksonville, AR 72076  
501-982-0581

## RESIDENTIAL OR COMMERCIAL BUILDING SEWER CONNECTION PERMIT

Street Address 140 John Harden DRLegal Description Ste 27 Renaissance Medical Spas, LLC

Facility to be connected to sewer:

Single Family Residence \_\_\_\_\_ \*Multi-family Residential \_\_\_\_\_ Units \_\_\_\_\_

\*Commercial Installation ☒ Description: New ConnectionWater Meter (s) Size 3/8"

\* Commercial installations, and multi-family installations of more than 4 dwelling units must be accompanied by a site plan showing the proposed building sewer.

Sewer line installation by Brien Black PlumbingAddress UP 54/72General Contractor Stevens Commercial Contractors, IncAddress 109 S. Charles St. Searcy, AR 72143501279-3039

In consideration of the granting of this permit the undersigned agrees:

1. To accept and abide by all provisions of the Jacksonville Wastewater Utility.
2. To maintain the building sewer at no expense to the Utility, to the point of connection with the public sewer main.
3. To notify the utility's inspector when the building sewer is ready for inspection and connection to the public sewer main, but before any portion of the work is covered.

Fees: Connection Fee \$ 75.00Receipt No. 0216

Tap Charge \$ \_\_\_\_\_

Receipt No. \_\_\_\_\_

Inspection Fee \$ 25.00Receipt No. 0216

Street Cut \$ \_\_\_\_\_

Receipt No. \_\_\_\_\_

## APPLICANT

Signed [Signature]

- ☐ Plumbing Contractor  
☒ General Contract  
☐ Owner (Address)

Kerin Spence  
278 8252Previously license done per Jan 14/08  
Water Dept hooked on 12/1/08Completed

## APPROVED

Jacksonville Wastewater Utility

By: Jessica Kendrick Date: 6-26-08

Contractor Dp

No 62212

**JACKSONVILLE WATER COMMISSION**  
Jacksonville, Arkansas

Date 6-26-08

Customer Name Stevens Commercial Contractors Received by LFL

Amount Sixty five Meter Deposit (refundable) 65.00

Address 109 South Charles ST Searcy AR 72143 Service Charge (non-refundable) 10.00

Paid by [Signature] Total Received 75.00

**JACKSONVILLE WATER COMMISSION**

Jacksonville, Arkansas

18643

June 26 20 08

RECEIVED OF Stevens Commercial Contr \$ 375.00

Three hundred seventy five and no  
FOR 5/8 meter only

120 John Harden Dr.  
Ste 5

**JACKSONVILLE WATER COMMISSION**

By S. C. Cline