



JACKSONVILLE WASTEWATER UTILITY

248 Cloverdale Rd.
Jacksonville, AR 72076
501-982-0581

No. 08- 0212

RESIDENTIAL OR COMMERCIAL BUILDING SEWER CONNECTION PERMIT

Street Address 1401 Lost Creek Dr.

Legal Description LOT 46 Lost Creek Estates Ph 1

Facility to be connected to sewer:

Single Family Residence ☒ *Multi-family Residential _____ Units _____

*Commercial Installation _____ Description: _____

Water Meter (s) Size 5/8

* Commercial installations, and multi-family installations of more than 4 dwelling units must be accompanied by a site plan showing the proposed building sewer.

Sewer line installation by Foster Piping 501 454 0368

Address _____

General _____

Address _____

In consid _____

1. To ac _____

2. To ma _____

public LOST CREEK DR

3. To no _____

to the 3694

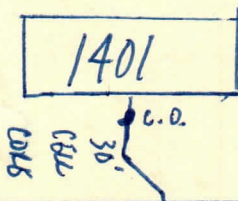

Fees: Connection Fee \$ 152 11-5-08 Receipt No. 0386

Tap Charge \$ _____ Receipt No. _____

Inspection Fee \$ 25.00 1/2/09 Receipt No. 8052

Street Cut \$ _____ Receipt No. _____

APPLICANT

Signed _____

☐ Plumbing Contractor

☐ General Contract

☐ Owner (Address _____)

APPROVED

Jacksonville Wastewater Utility

By: _____ Date: 11/3/08

completed
1/2/09