



JACKSONVILLE WASTEWATER UTILITY
248 Cloverdale Rd.
Jacksonville, AR 72076
501-982-0581

No. 14- 0140

RESIDENTIAL OR COMMERCIAL BUILDING SEWER CONNECTION PERMIT

Street Address 1407 Lost Creek

Legal Description Lot #3, Lost Creek

Facility to be connected to sewer:

Single Family Residence X *Multi-family Residential _____ Units _____

*Commercial Installation _____ Description: New Connection

Water Meter (s) Size 5/8"

* Commercial installations, and multi-family installations of more than 4 dwelling units must be accompanied by a site plan showing the proposed building sewer.

Sewer line Installation by Jackson Plumbing Rte 1 (58-5130)

Address _____

General _____

Address _____

In consid _____

1. To ac _____

2. To ma public _____

3. To not to the _____

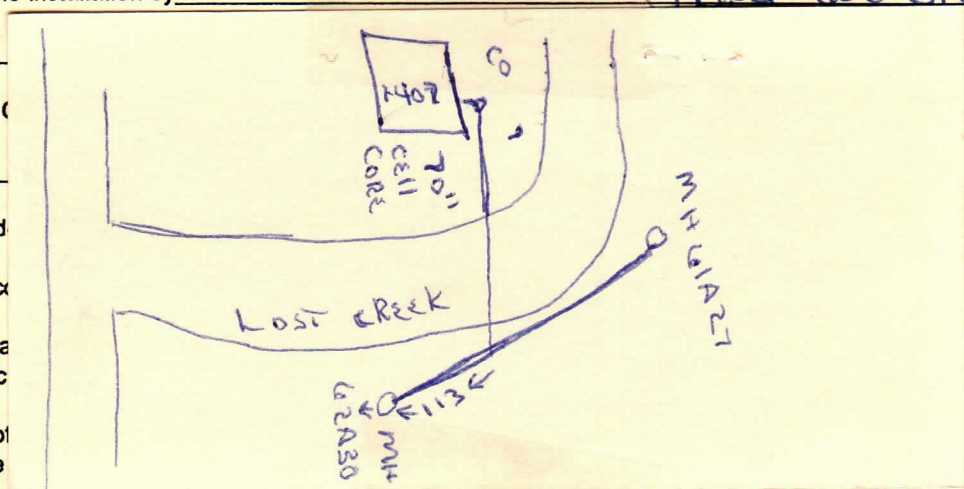

Fees: Connection Fee \$ 75.00 11/14

Receipt No. 875274

Tap Charge \$ _____

Receipt No. _____

Inspection Fee \$ 25.00 10/14/14

Receipt No. 875292

Street Cut \$ _____

Receipt No. _____

APPLICANT Signed [Signature]

☐ Plumbing Contractor

☐ General Contract

☐ Owner (Address _____)

David M.

Complete
12/3/14
[Signature]

APPROVED
Jacksonville Wastewater Utility

By: [Signature] Date: 9-30-14