



No. 98 - 339

## JACKSONVILLE WASTEWATER UTILITY

248 Cloverdale Road • P.O. Box 69  
Jacksonville, AR 72078-0069  
982-0581

## RESIDENTIAL OR COMMERCIAL BUILDING SEWER CONNECTION PERMIT

Street Address 1437 Phillips

Legal Description \_\_\_\_\_

Facility to be connected to sewer:

Single Family Residence ☒ \*Multi-family Residential \_\_\_\_\_ Units \_\_\_\_\_\*Commercial Installation \_\_\_\_\_ Description: Street CutWater Meter (s) Size 5/8

\* Commercial installations, and multi-family installations of more than 4 dwelling units must be accompanied by a site plan showing the proposed building sewer.

Sewer line installation by AAA Plumbing 9850360Address PO Box 38 Clark AR 72078

General

Address

In consideration of

1. To a

2. To a public

3. To a third party

Fees:

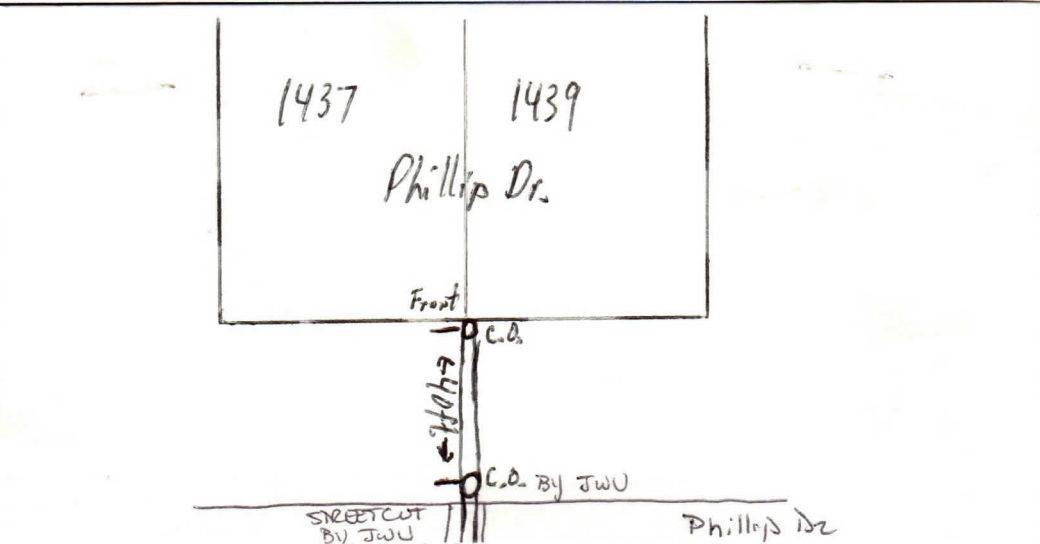
Inspection Fee \$ 6.00

Receipt No. \_\_\_\_\_

Total Fees \$ \_\_\_\_\_

APPLICANT

Signed per phone☒ Plumbing Contractor☐ General Contract☐ Owner (Address \_\_\_\_\_)

APPROVED

Jacksonville Wastewater Utility

By: Karen Stivers Date: 12-9-98