



JACKSONVILLE WASTEWATER UTILITY

RESIDENTIAL OR COMMERCIAL BUILDING SEWER CONNECTION PERMIT

Street Address 1503 Gregory

Legal Description _____

Facility to be connected to sewer:

Single Family Residence ☒ * Multi-family Residential _____ Units _____

* Commercial Installation _____ Description: _____

Water Meter (s) size replacement

* Commerical installations, and multi-family installations of more than 4 dwelling units must be accompanied by a site plan showing the proposed building sewer.

Sewer line installation by David Cook

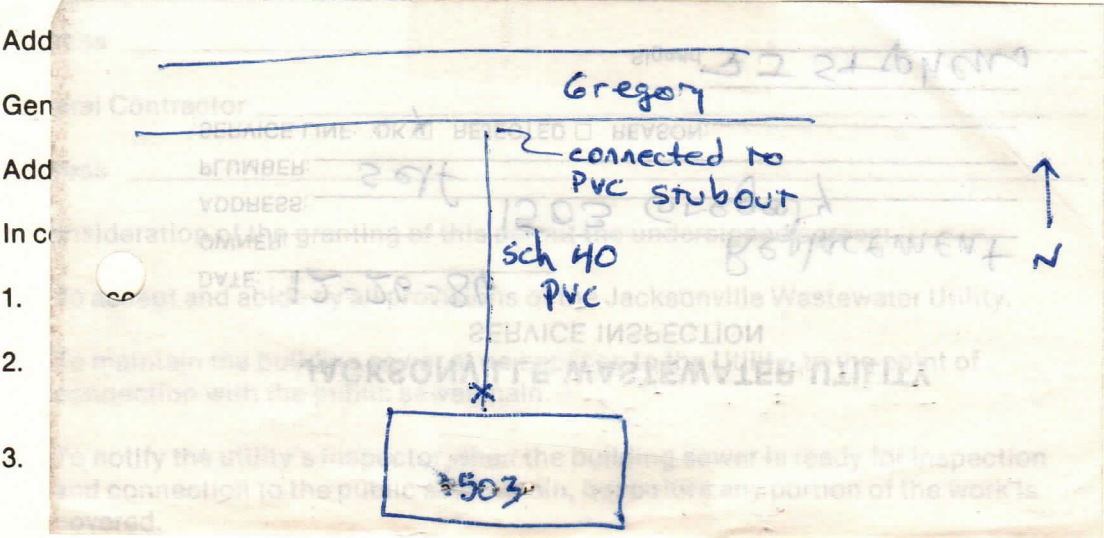

Fees: Connection Fee \$ _____
Tap Charge \$ _____
Inspection Fee \$ 6.00
Total Fees \$ 6.00

Receipt No. _____
Receipt No. _____
Receipt No. 2569 12/26/86

APPLICANT
Signed David Cook
☐ Plumbing Contractor
☐ General Contract
☐ Owner (Address _____)

APPROVED
Jacksonville Wastewater Utility

By: _____ Date: 12/26/86



JACKSONVILLE WASTEWATER UTILITY
248 Cloverdale Rd.
Jacksonville, AR 72076
501-982-0581

SLD
No. 14- 0061

RESIDENTIAL OR COMMERCIAL BUILDING SEWER CONNECTION PERMIT

Street Address 1503 Gregory Street

Legal Description _____

Facility to be connected to sewer:

Single Family Residence ☒ *Multi-family Residential _____ Units _____

*Commercial Installation 5/8 Description: Street Cut

Water Meter (s) Size _____

* Commercial installations, and multi-family installations of more than 4 dwelling units must be accompanied by a site plan showing the proposed building sewer.

Sewer line Installation by JWWU

Address _____

General _____

Address _____

In consideration _____

1. To account _____

2. To maintain public _____

3. To not to the _____

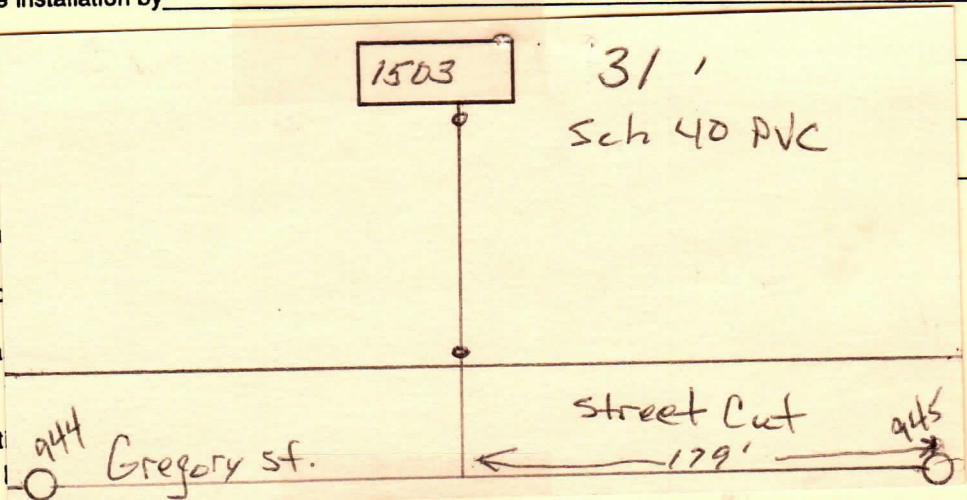

Fees: Connection Fee \$ _____

Receipt No. _____

Tap Charge \$ _____

Receipt No. _____

Inspection Fee \$ _____

Receipt No. _____

Street Cut \$ 1050.00

Receipt No. 875153

APPLICANT Renate Spurrer
Signed _____

☐ Plumbing Contractor

☐ General Contract

☐ Owner (Address _____)

APPROVED
Jacksonville Wastewater Utility

By: [Signature] Date: 6/17/14

Complete
6/24/14
[Signature]