



No. 99 0160

JACKSONVILLE WASTEWATER UTILITY

248 Cloverdale Road • P.O. Box 69
Jacksonville, AR 72078-0069
982-0581

RESIDENTIAL OR COMMERCIAL BUILDING SEWER CONNECTION PERMIT

Street Address 1504 Dogwood DR

Legal Description _____

Facility to be connected to sewer:

Single Family Residence ☒ *Multi-family Residential _____ Units _____*Commercial Installation _____ Description: Rep SSESWater Meter (s) Size 3/8

* Commercial installations, and multi-family installations of more than 4 dwelling units must be accompanied by a site plan showing the proposed building sewer.

Sewer line installation by Jim Perceck Realty

Address _____

General _____

Address _____

In connection with _____

1. To _____

2. To _____

3. To _____

to _____

Fees: _____



JACKSONVILLE WASTEWATER UTILITY

SERVICE INSPECTION

PERMIT NO. _____

DATE: 5-27-99

OWNER: _____

ADDRESS: 1504 Dogwood Dr.

PLUMBER: _____

SERVICE LINE: ☒ OK ☐ REJECTED ☐ REASON: _____SIGNED Daryl Pickens

Tap Charge \$ _____

Inspection Fee \$ 600

Total Fees \$ _____

Receipt No. _____

Receipt No. 9210

APPLICANT

Signed Per mail☐ Plumbing Contractor☐ General Contract☐ Owner (Address _____)

APPROVED

Jacksonville Wastewater Utility

By: Karen Strawn Date: 5-27-99



No. 03-0279

JACKSONVILLE WASTEWATER UTILITY248 Cloverdale Road · P.O. Box 69
Jacksonville, AR 72078-0069
982-0581**RESIDENTIAL OR COMMERCIAL BUILDING SEWER CONNECTION PERMIT**Street Address 1504 Dogwood

Legal Description _____

Facility to be connected to sewer:

Single Family Residence _____ *Multi-family Residential _____ Units _____

*Commercial Installation _____ Description: Replacement

Water Meter (s) Size _____

* Commercial installations, and multi-family installations of more than 4 dwelling units must be accompanied by a site plan showing the proposed building sewer.

Sewer line installation by Thon's Express Plumbers

Address _____

General _____

Address _____

In consid _____

1. To ac _____

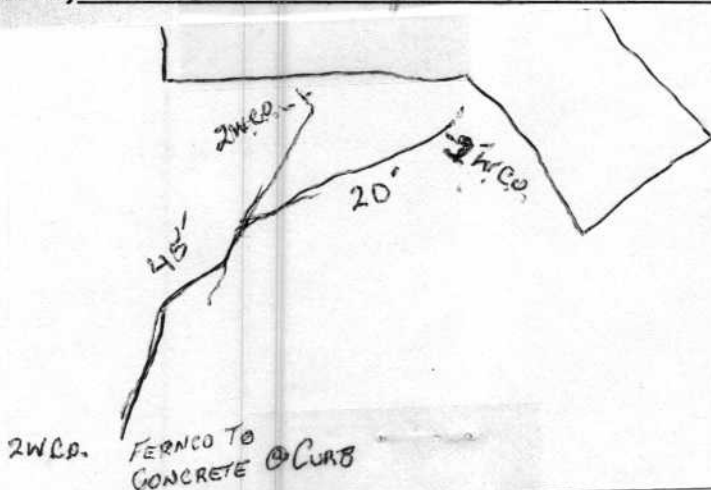
2. To ma
public _____3. To not
to the _____

Fees: Connection Fee \$ _____ Receipt No. _____

Tap Charge \$ _____ Receipt No. _____

Inspection Fee \$ 6.00 Receipt No. 2117

Street Cut \$ _____ Receipt No. _____

APPLICANTSigned Jeff Currence Jeff Currence☐ Plumbing Contractor☐ General Contract☐ Owner (Address _____)**APPROVED**

Jacksonville Wastewater Utility

By: Paul J. Gordon Date: 4 November 03



JACKSONVILLE WASTEWATER UTILITY

248 Cloverdale Rd.
Jacksonville, AR 72076
501-982-0581

No. 17- 077

RESIDENTIAL OR COMMERCIAL BUILDING SEWER CONNECTION PERMIT

Street Address 1504 Dogwood

Legal Description _____

Facility to be connected to sewer:

Single Family Residence _____ *Multi-family Residential _____ Units _____

*Commercial Installation _____ Description: _____

Water Meter (s) Size _____

* Commercial installations, and multi-family installations of more than 4 dwelling units must be accompanied by a site plan showing the proposed building sewer.

Sewer line installation by Jacksonville Water / 5a /

Address _____

General _____

Address _____

In consid _____

1. To ac _____

2. To m
public _____

3. To ne
to the _____

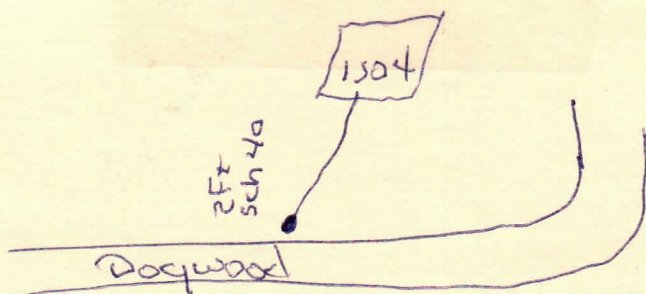

Fees: Connection Fee \$ _____

Receipt No. _____

Tap Charge \$ _____

Receipt No. _____

Inspection Fee \$ ~~110~~ _____

Receipt No. nc

Street Cut \$ _____

Receipt No. _____

APPLICANT

Signed Robert Hutson

☐ Plumbing Contractor

☐ General Contract

☐ Owner (Address _____)

David
5/3/17

Completed
5/3/17

APPROVED

Jacksonville Wastewater Utility

By: Cathy Reed Date: 5/3/17