



No. 95 -

100

JACKSONVILLE WASTEWATER UTILITY

248 Cloverdale Road • P.O. Box 69
Jacksonville, AR 72078-0069
982-0581

RESIDENTIAL OR COMMERCIAL BUILDING SEWER CONNECTION PERMITStreet Address 1512 Keaton

Legal Description _____

Facility to be connected to sewer:

Single Family Residence ☒ *Multi-family Residential _____ Units _____

*Commercial Installation _____ Description: _____

Water Meter (s) Size 3/8

* Commercial installations, and multi-family installations of more than 4 dwelling units must be accompanied by a site plan showing the proposed building sewer.

Sewer line installation by Owner Gary Baxter

Address _____

General _____

Address _____

In con _____

1. To _____

2. To _____

put _____

3. To _____

to t _____

Fees: _____

Tap Charge \$ 34.82Inspection Fee \$ 6.00Total Fees \$ 41.82Receipt No. 434253 (7304)

Receipt No. _____

APPLICANT

Signed Miane Baxter☐ Plumbing Contractor☐ General Contract☐ Owner (Address _____)

APPROVED

Jacksonville Wastewater Utility

By: Susan Davitt Date: 1-28-95



No. 96-055

JACKSONVILLE WASTEWATER UTILITY

248 Cloverdale Road • P.O. Box 69
Jacksonville, AR 72078-0069
982-0581

RESIDENTIAL OR COMMERCIAL BUILDING SEWER CONNECTION PERMIT

Street Address 1512 Keaton

Legal Description _____

Facility to be connected to sewer:

Single Family Residence ☒ *Multi-family Residential _____ Units _____*Commercial Installation _____ Description: replaceWater Meter (s) Size 5/8

* Commercial installations, and multi-family installations of more than 4 dwelling units must be accompanied by a site plan showing the proposed building sewer.

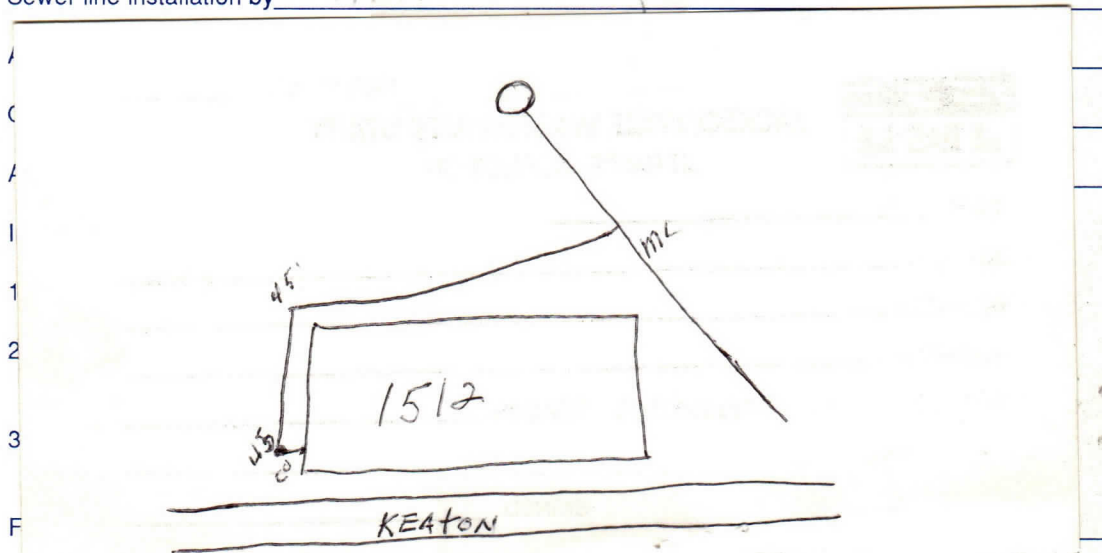
Sewer line installation by AAA PlumbingTap Charge \$ 34.82Inspection Fee \$ 6.00Total Fees \$ 40.82Receipt No. 5285

Receipt No. _____

APPLICANT

Signed per call Sal☐ Plumbing Contractor☐ General Contract☐ Owner (Address _____)

APPROVED

Jacksonville Wastewater Utility

By: Dana Duncan Date: 4-10-96