



JACKSONVILLE WASTEWATER UTILITY

No 582

RESIDENTIAL OR COMMERCIAL BUILDING SEWER CONNECTION PERMIT

Street Address 1512 N. ...

Legal Description _____

Facility to be connected to sewer:

Single Family Residence _____ *Multi-family Residential _____ Units _____

*Commercial Installation _____ Description: _____

Water Meter (s) size _____

*Commerical installations, and multi-family installations of more than 4 dwelling units must be accompanied by a site plan showing the proposed building sewer.

Sewer line installation by ...

Address _____

General

Address

In consi

1. To a

2. To n
conl

3. To n
and
cove

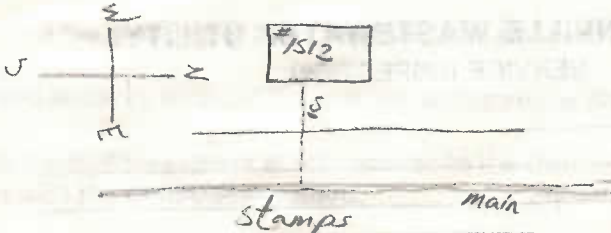

Fees:

Tap Charge \$...

Inspection Fee \$...

Total Fees \$...

Receipt No. 2011 8/14/16

Receipt No. 2011 8/14/16

APPLICANT

Signed David ...

- ☐ Plumbing Contractor
☐ General Contract
☐ Owner (Address _____)

APPROVED

Jacksonville Wastewater Utility

By: _____

Date: 8/14/16



JACKSONVILLE WASTEWATER UTILITY
248 Cloverdale Rd.
Jacksonville, AR 72076
501-982-0581

No. 13- 0057

RESIDENTIAL OR COMMERCIAL BUILDING SEWER CONNECTION PERMIT

Street Address 1512 Stamps Street

Legal Description _____

Facility to be connected to sewer:

Single Family Residence ☒ *Multi-family Residential _____ Units _____

*Commercial Installation _____ Description: Repair

Water Meter (s) Size 5/8"

* Commercial installations, and multi-family installations of more than 4 dwelling units must be accompanied by a site plan showing the proposed building sewer.

Sewer line installation by Arrow Plumbing

Address _____

General Con 1512 STAMPS

Address 91 ft x 40 ft

In consideration 150 ft to H 2023

1. To accept
2. To maintain public sewer
3. To notify to the public

Fees: Cor _____

Tap Charge \$ _____

Inspection Fee \$ 25.00

Street Cut \$ _____

Receipt No. _____

Receipt No. on file

Receipt No. _____

APPLICANT

Signed on file

☐ Plumbing Contractor

☐ General Contract

☐ Owner (Address _____)

APPROVED
Jacksonville Wastewater Utility

By: Jessica Kendrick Date: 3/12/13

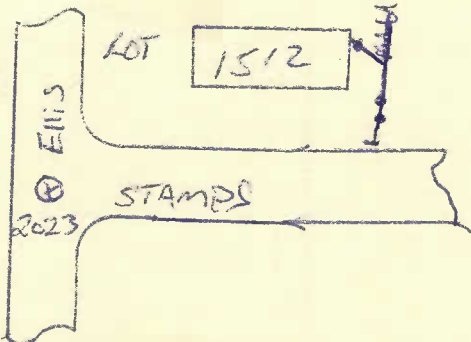

Mark

complete
3/13/13



JACKSONVILLE WASTEWATER UTILITY
248 Cloverdale Rd.
Jacksonville, AR 72076
501-982-0581

No. 17-055

RESIDENTIAL OR COMMERCIAL BUILDING SEWER CONNECTION PERMIT

Street Address 1512 Stamps St

Legal Description _____

Facility to be connected to sewer:

Single Family Residence ☒ *Multi-family Residential _____ Units _____

*Commercial Installation _____ Description: Repair

Water Meter (s) Size 5/8

* Commercial installations, and multi-family installations of more than 4 dwelling units must be accompanied by a site plan showing the proposed building sewer.

Sewer line installation by Brandt Plumbing James 246-1182

Address _____

General _____

Address _____

In consid _____

1. To a _____

2. To a public _____

3. To a _____ to the _____

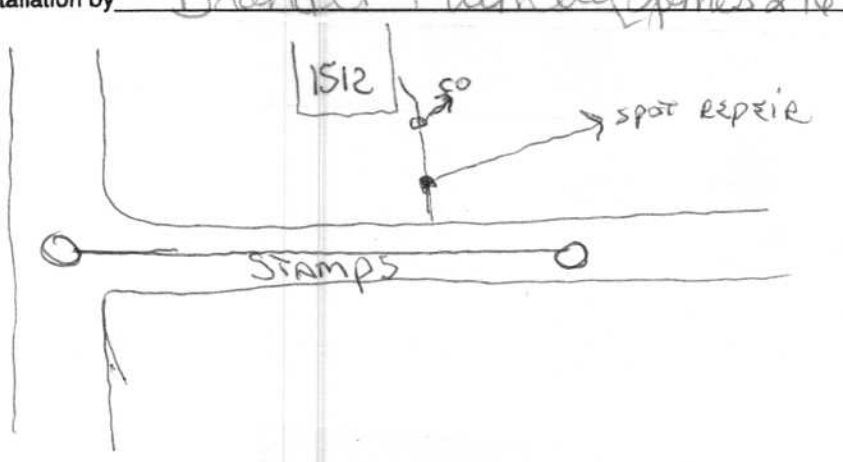

Fees: Connection Fee \$ _____ Receipt No. _____

Tap Charge \$ _____ Receipt No. _____

Inspection Fee \$ 25.00 Receipt No. 174148

Street Cut \$ _____ Receipt No. _____

APPLICANT Signed [Signature]

- ☐ Plumbing Contractor
☐ General Contract
☐ Owner (Address _____)

Complete
3/20/17

APPROVED
Jacksonville Wastewater Utility

By: [Signature] Date: 3/20/17



JACKSONVILLE WASTEWATER UTILITY
248 Cloverdale Rd.
Jacksonville, AR 72076
501-982-0581

No. 17- **172**

RESIDENTIAL OR COMMERCIAL BUILDING SEWER CONNECTION PERMIT

Street Address 1512 B Stamps

Legal Description _____

Facility to be connected to sewer:

Single Family Residence ☒ *Multi-family Residential _____ Units _____

*Commercial Installation _____ Description: Street Cut

Water Meter (s) Size 5/8"

* Commercial installations, and multi-family installations of more than 4 dwelling units must be accompanied by a site plan showing the proposed building sewer.

Sewer line installation by JWWU - Lulce

Address _____

General C _____

Address _____

In consider _____

1. To acc _____

2. To ma public _____

3. To not to the _____

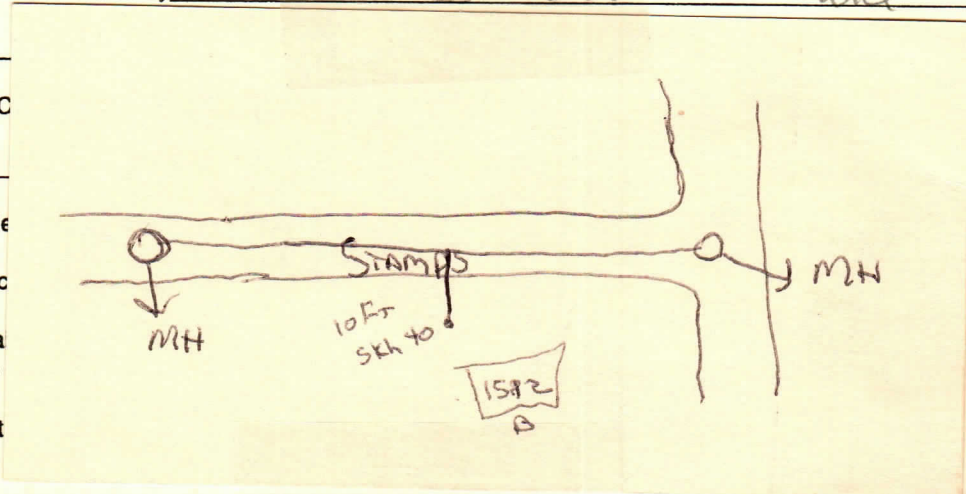

Fees: Connection Fee \$ _____

Receipt No. _____

Tap Charge \$ _____

Receipt No. _____

Inspection Fee \$ Ø

Receipt No. N/C

Street Cut \$ Ø

Receipt No. N/C

APPLICANT

Signed N/A

☐ Plumbing Contractor

☐ General Contract

☐ Owner (Address _____)

APPROVED
Jacksonville Wastewater Utility

By: Jessica Kendrick Date: 10-18-17

Complete
10/18/17
W