



No. 01216

## JACKSONVILLE WASTEWATER UTILITY

248 Cloverdale Road · P.O. Box 69  
Jacksonville, AR 72078-0069  
982-0581

## RESIDENTIAL OR COMMERCIAL BUILDING SEWER CONNECTION PERMIT

Street Address 1515 Gregory

Legal Description \_\_\_\_\_

Facility to be connected to sewer:

Single Family Residence ☒ \*Multi-family Residential \_\_\_\_\_ Units \_\_\_\_\_\*Commercial Installation \_\_\_\_\_ Description: replaceWater Meter (s) Size 5/8

\* Commercial installations, and multi-family installations of more than 4 dwelling units must be accompanied by a site plan showing the proposed building sewer.

Sewer line installation by Maxson Plumbing

Address \_\_\_\_\_

General \_\_\_\_\_

Address \_\_\_\_\_

In consid \_\_\_\_\_

1. To ac \_\_\_\_\_

2. To m  
public \_\_\_\_\_3. To ne  
to the \_\_\_\_\_

Fees: \_\_\_\_\_

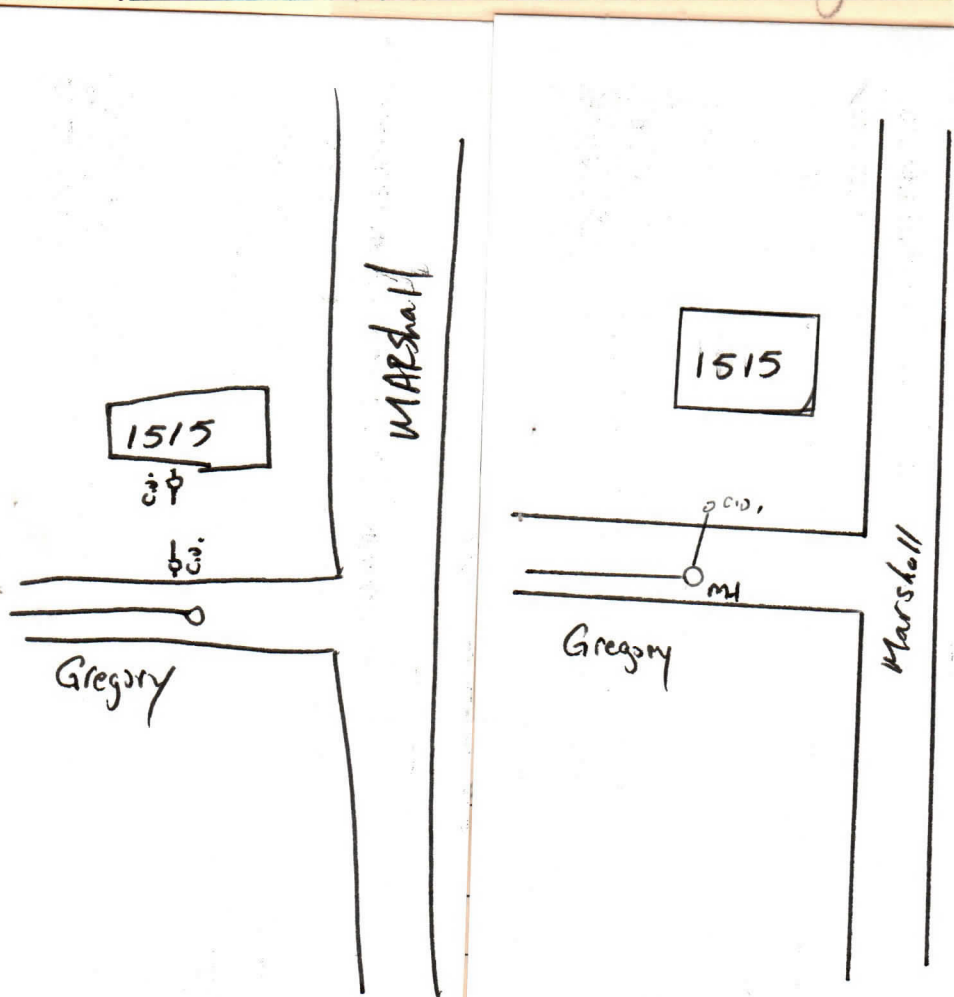
APPLIC  
Signed \_\_\_\_\_APPRO  
Jackso \_\_\_\_\_By: Wally Reed Date: 1/24/01



# JACKSONVILLE WASTEWATER UTILITY

248 Cloverdale Rd.  
Jacksonville, AR 72076  
501-982-0581

No. 07-0139

## RESIDENTIAL OR COMMERCIAL BUILDING SEWER CONNECTION PERMIT

Street Address 1515 Gregory

Legal Description \_\_\_\_\_

Facility to be connected to sewer:

Single Family Residence ☒ \*Multi-family Residential \_\_\_\_\_ Units \_\_\_\_\_

\*Commercial Installation \_\_\_\_\_ Description: Replacement

Water Meter (s) Size 5/8"

\* Commercial installations, and multi-family installations of more than 4 dwelling units must be accompanied by a site plan showing the proposed building sewer.

Sewer line installation by Maxson Plumbing 501-834-0600

Address \_\_\_\_\_

General \_\_\_\_\_

Address \_\_\_\_\_

In consid \_\_\_\_\_

1. To ac \_\_\_\_\_

2. To ma public GREGORY ST.

3. To no to the TLBS IN TO MH

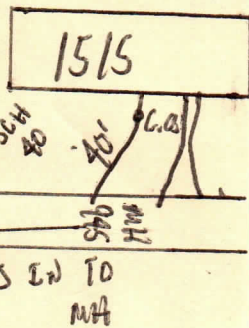

Fees: Connection Fee \$ \_\_\_\_\_ Receipt No. \_\_\_\_\_

Tap Charge \$ \_\_\_\_\_ Receipt No. \_\_\_\_\_

Inspection Fee \$ 12.00 Receipt No. on Acct

Street Cut \$ \_\_\_\_\_ Receipt No. \_\_\_\_\_

### APPLICANT

Signed \_\_\_\_\_

☐ Plumbing Contractor

☐ General Contract

☐ Owner (Address \_\_\_\_\_)

### APPROVED

Jacksonville Wastewater Utility

By: Jessica Kendrick Date: 9-27-07

Inspected  
9-27-07