



No. 24- 0050

JACKSONVILLE WASTEWATER UTILITY
248 Cloverdale Rd.
Jacksonville, AR 72076
501-982-0581

RESIDENTIAL OR COMMERCIAL BUILDING SEWER CONNECTION PERMIT

Street Address 1513 1/2 1515 STAMPS Street

Legal Description lot 23

Facility to be connected to sewer:

Single Family Residence _____ *Multi-family Residential ☒ Units _____

*Commercial Installation _____ Description: New connections

Water Meter (s) Size 5/8

* Commercial installations, and multi-family installations of more than 4 dwelling units must be accompanied by a site plan showing the proposed building sewer.

Sewer line installation by Bond PBM Plumber Kelly 501-213-9110

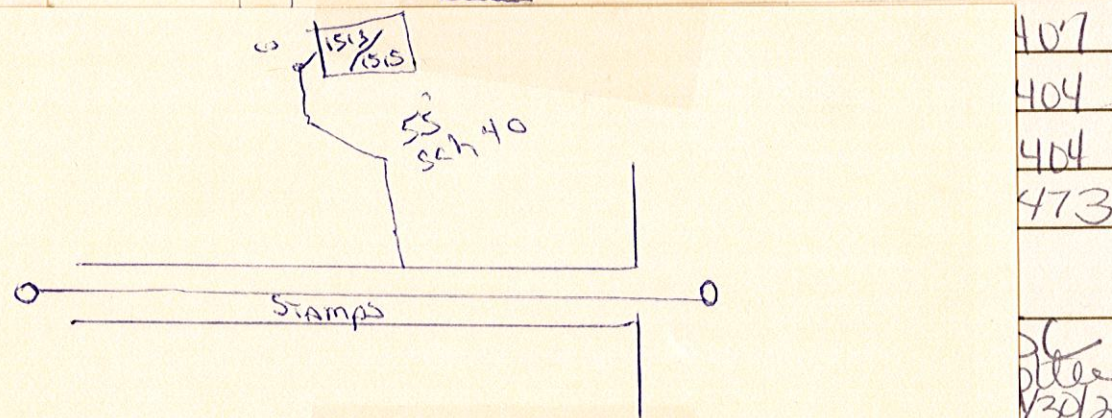
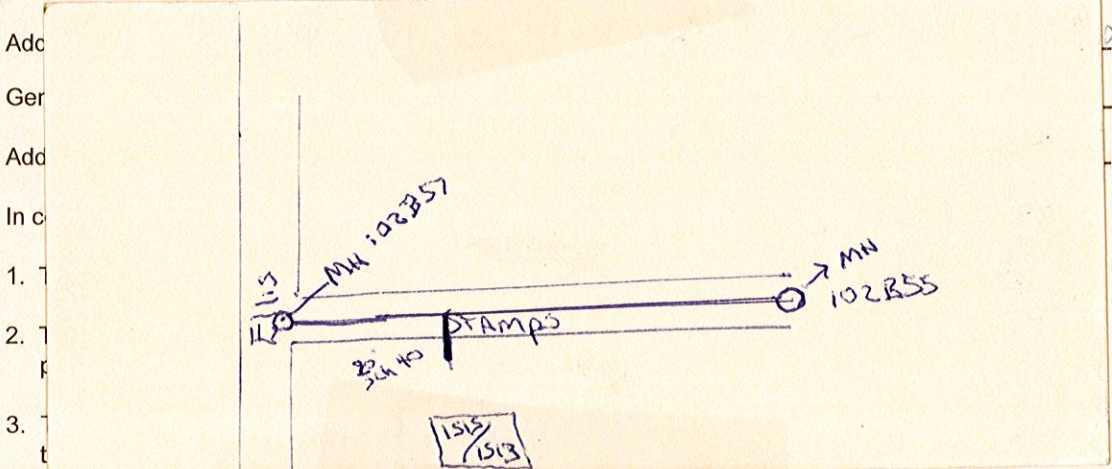

APPROVED
Jacksonville Wastewater Utility

By: CSpradshaw Date: 3.29.24

407
404
404
473
complete
EY 6/2024



JACKSONVILLE WASTEWATER UTILITY
248 Cloverdale Rd.
Jacksonville, AR 72076
501-982-0581

No. 25- 0077

RESIDENTIAL OR COMMERCIAL BUILDING SEWER CONNECTION PERMIT

Street Address 1515 + 1517 Stamps Street

Legal Description _____

Facility to be connected to sewer:

Single Family Residence ✓ *Multi-family Residential _____ Units _____

*Commercial Installation _____ Description: New Connection

Water Meter (s) Size 5/8

* Commercial installations, and multi-family installations of more than 4 dwelling units must be accompanied by a site plan showing the proposed building sewer.

Sewer line installation by Bonds

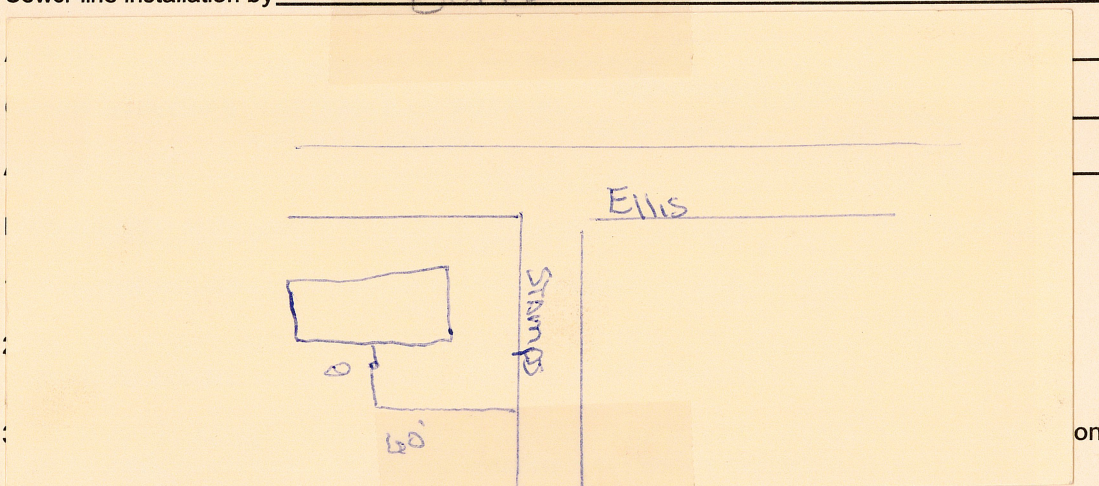

Fee:	Connection Fee	\$ _____	Receipt No. _____
	Tap Charge	\$ _____	Receipt No. _____
	Inspection Fee	\$ _____	Receipt No. _____
	Street Cut	\$ _____	Receipt No. _____

APPLICANT

Signed _____

☐ Plumbing Contractor

☐ General Contract

☒ Owner (Address _____)

Complete
4/1/2025

APPROVED
Jacksonville Wastewater Utility

By: [Signature] Date: 4/1/2025