



No. 01230

JACKSONVILLE WASTEWATER UTILITY

248 Cloverdale Road · P.O. Box 69
Jacksonville, AR 72078-0069
982-0581

RESIDENTIAL OR COMMERCIAL BUILDING SEWER CONNECTION PERMIT

Street Address 1517 Haley CtLegal Description Lot 4 Jordan Acres

Facility to be connected to sewer:

Single Family Residence ☒ *Multi-family Residential _____ Units _____

*Commercial Installation _____ Description: _____

Water Meter (s) Size 5/8

* Commercial installations, and multi-family installations of more than 4 dwelling units must be accompanied by a site plan showing the proposed building sewer.

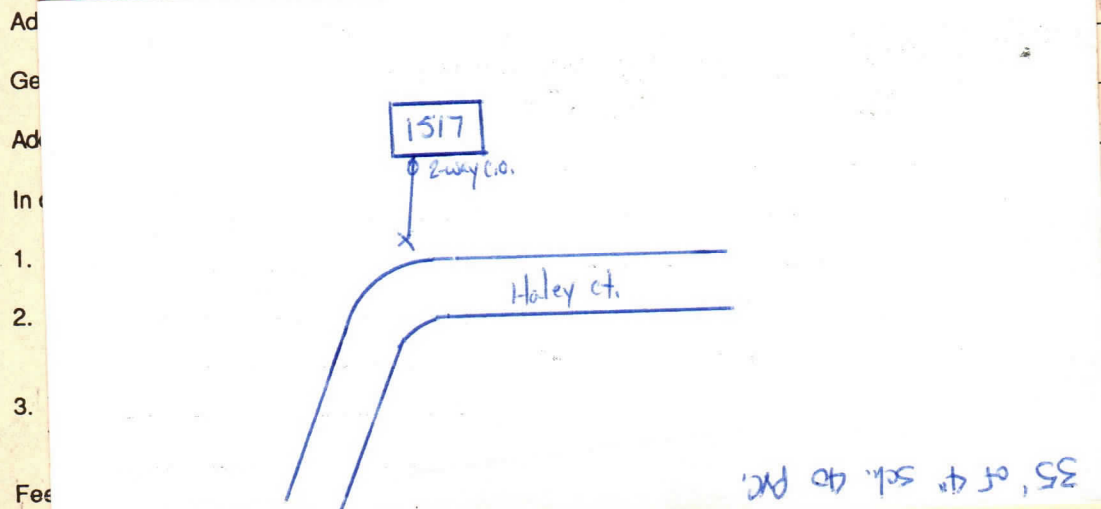
Sewer line installation by A-1

Tap Charge \$ _____

Receipt No. _____

Inspection Fee \$ 6.00 2-20-02Receipt No. 9060Total Fees \$ 25.00

APPLICANT

Signed Rebecca Camp☐ Plumbing Contractor☒ General Contract☐ Owner (Address _____)

APPROVED

Jacksonville Wastewater Utility

By: Jesse Carter Date: 11-30-01