



JACKSONVILLE WASTEWATER UTILITY

248 Cloverdale Rd.
Jacksonville, AR 72076
501-982-0581

No. 19- 0028

RESIDENTIAL OR COMMERCIAL BUILDING SEWER CONNECTION PERMIT

Street Address 1517 Stamps Street

Legal Description _____

Facility to be connected to sewer:

Single Family Residence ☒ *Multi-family Residential _____ Units _____

*Commercial Installation _____ Description: repair

Water Meter (s) Size 5/8

* Commercial installations, and multi-family installations of more than 4 dwelling units must be accompanied by a site plan showing the proposed building sewer.

Sewer line installation by Maxson Plumbing - Troy 834-7700

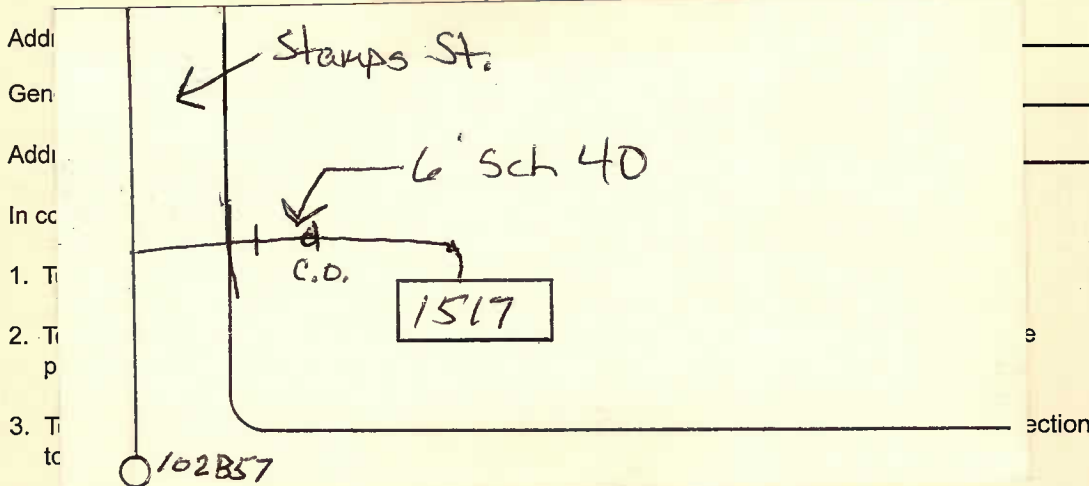

Fee: Connection Fee \$ _____
Tap Charge \$ _____
Inspection Fee \$ 25.00
Street Cut \$ _____

Receipt No. _____
Receipt No. _____
Receipt No. on acct
Receipt No. _____

APPLICANT

Signed on file

- ☐ Plumbing Contractor
☐ General Contract
☐ Owner (Address _____)

Warren

complete
3/21/19

APPROVED

Jacksonville Wastewater Utility

By: Julie Head Date: 3/21/19



No. 97-

130

JACKSONVILLE WASTEWATER UTILITY

248 Cloverdale Road • P.O. Box 69
Jacksonville, AR 72078-0069
982-0581

RESIDENTIAL OR COMMERCIAL BUILDING SEWER CONNECTION PERMIT

Street Address 1517 Stamps

Legal Description _____

Facility to be connected to sewer:

Single Family Residence ☒ *Multi-family Residential _____ Units _____*Commercial Installation _____ Description: repair (SSS)

Water Meter (s) Size _____

* Commercial installations, and multi-family installations of more than 4 dwelling units must be accompanied by a site plan showing the proposed building sewer.

Sewer line installation by George Hollowell

Address _____

General _____

Address _____

In cons _____

1. To a _____

2. To a _____

pub _____

3. To a _____

to the _____

Fees: replaced piece of pipeSIGNED Ken D. HillInspection Fee \$ 6.00Receipt No. 7191Total Fees \$ 6.00

APPLICANT

Signed George M. Hollowell☐ Plumbing Contractor☐ General Contract☐ Owner (Address _____)

APPROVED

Jacksonville Wastewater Utility

By: Dana Duncan Date: 4-1-97



JACKSONVILLE WASTEWATER UTILITY
248 Cloverdale Rd.
Jacksonville, AR 72076
501-982-0581

No. 25- 0077

RESIDENTIAL OR COMMERCIAL BUILDING SEWER CONNECTION PERMIT

Street Address 1515 + 1517 Stamps Street

Legal Description _____

Facility to be connected to sewer:

Single Family Residence ✓ *Multi-family Residential _____ Units _____

*Commercial Installation _____ Description: New Connection

Water Meter (s) Size 5/8

* Commercial installations, and multi-family installations of more than 4 dwelling units must be accompanied by a site plan showing the proposed building sewer.

Sewer line installation by Bonds

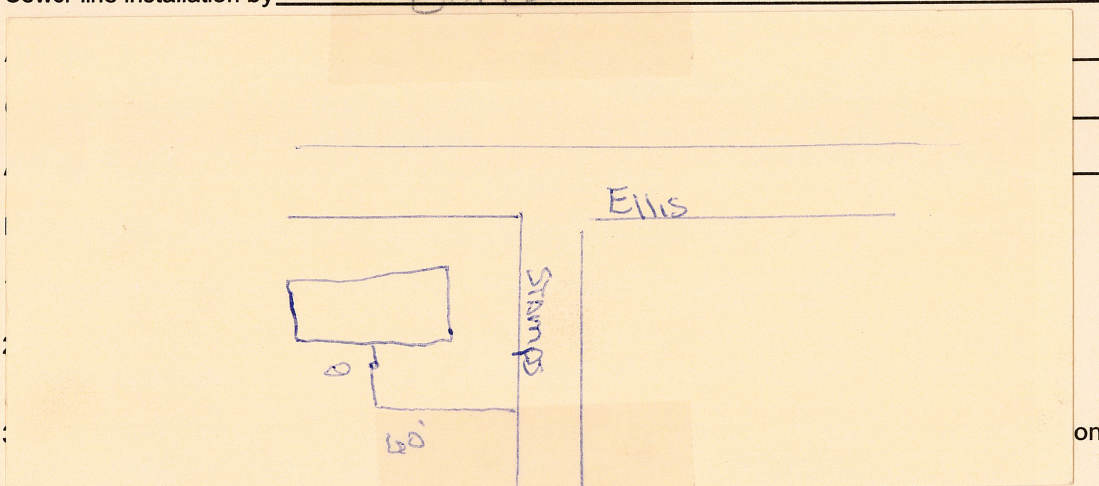

Fee:	Connection Fee	\$ _____	Receipt No. _____
	Tap Charge	\$ _____	Receipt No. _____
	Inspection Fee	\$ _____	Receipt No. _____
	Street Cut	\$ _____	Receipt No. _____

APPLICANT

Signed _____

☐ Plumbing Contractor

☐ General Contract

☒ Owner (Address _____)

Complete
4/1/2025

APPROVED
Jacksonville Wastewater Utility

By: [Signature] Date: 4/1/2025