



No. 91 - 000112

JACKSONVILLE WASTEWATER UTILITY
248 Cloverdale Road · P.O. Box 69
Jacksonville, AR 72076
982-0581

RESIDENTIAL OR COMMERCIAL BUILDING SEWER CONNECTION PERMIT

Street Address 1519 & 1517 Phillip Dr.

Legal Description _____

Facility to be connected to sewer:

Single Family Residence _____ *Multi-family Residential _____ Units _____

*Commercial Installation _____ Description: Repair

Water Meter (s) Size _____

* Commercial installations, and multi-family installations of more than 4 dwelling units must be accompanied by a site plan showing the proposed building sewer.

Sewer line installation by Circle M Plumbing

Address _____

General _____

Address _____

In cons _____

1. To a _____

2. To r
publ

3. To r
to th

Fees:

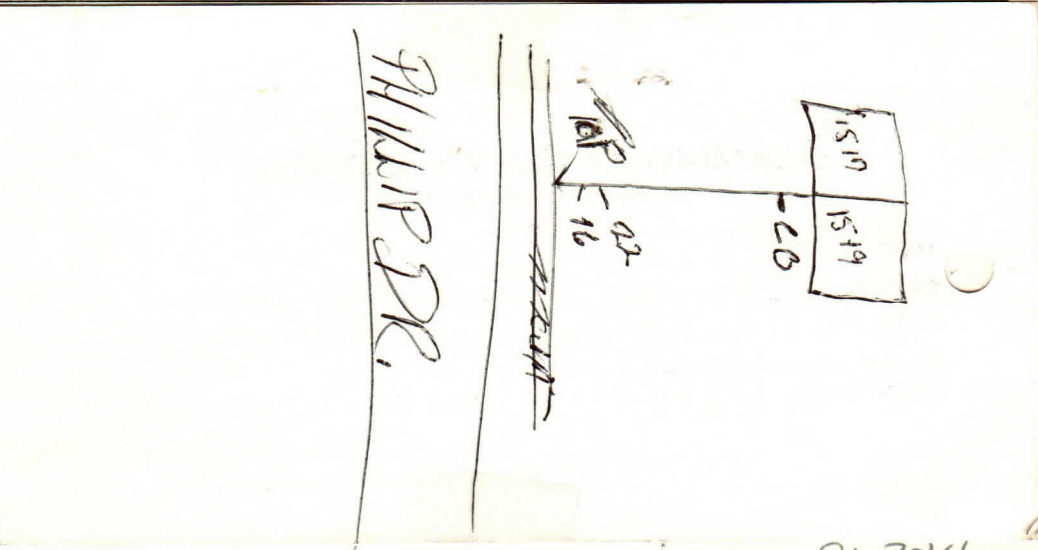

Inspection Fee \$ 6.00

Receipt No. 91-384

Total Fees \$ 39.23

APPLICANT

Signed Thomas Monteen

- ☒ Plumbing Contractor
☐ General Contract
☐ Owner (Address _____)

APPROVED
Jacksonville Wastewater Utility

By: Karla Gantham Date: 10/15/91